

AGENDA

Meeting: Southern Area Licensing Sub Committee

Place: Online

Date: Tuesday 13 April 2021

Time: 11.00 am

Please direct any enquiries on this Agenda to Lisa Moore, of Democratic Services, County Hall, Bythesea Road, Trowbridge, direct line 01722 434560 or email lisa.moore@wiltshire.gov.uk

Press enquiries to Communications on direct lines (01225) 713114/713115.

This Agenda and all the documents referred to within it are available on the Council's website at www.wiltshire.gov.uk

Membership:

Cllr Allison Bucknell
Cllr Ernie Clark

Cllr Jose Green

Substitutes:

Cllr Pip Ridout

Member of the public are able to view this meeting online [here](#)

Those taking part in the meeting will be sent a joining link by the Licensing Officer.

Guidance on how to join a Teams meeting can be found [here](#).

Recording and Broadcasting Information

Wiltshire Council may record this meeting for live and/or subsequent broadcast. At the start of the meeting, the Chairman will confirm if all or part of the meeting is being recorded. The images and sound recordings may also be used for training purposes within the Council.

By submitting a statement or question for an online meeting you are consenting that you will be recorded presenting this, or this may be presented by an officer during the meeting, and will be available on the public record. The meeting may also be recorded by the press or members of the public.

Any person or organisation choosing to film, record or broadcast any meeting of the Council, its Cabinet or committees is responsible for any claims or other liability resulting from them so doing and by choosing to film, record or broadcast proceedings they accept that they are required to indemnify the Council, its members and officers in relation to any such claims or liabilities.

Details of the Council's Guidance on the Recording and Webcasting of Meetings is available on request. Our privacy policy can be found [here](#).

AGENDA

1 **Election of Chairman**

To elect a Chairman for the meeting of the Sub Committee.

2 **Apologies for Absence/Substitutions**

To receive any apologies for absence and to note any substitutions.

3 **Procedure for the Meeting** (*Pages 5 - 12*)

The Chairman will explain the attached procedure for the members of the public present.

4 **Chairman's Announcements**

Any relevant announcements.

5 **Declarations of Interest**

To receive any declarations of disclosable interests or dispensations granted by the Standards Committee.

6 **Licensing Application** (*Pages 13 - 18*)

To consider and determine an application for a variation of a Premises Licence in respect of Green Hill Farm Caravan and Campsite, New Road, Landford made by Lovat Parks LTD

6a **Appendix 1 - Licence Variation Application & Premises Plan**
(*Pages 19 - 44*)

- Appendix 1 – Variation Application
- Doc 2 – Premises Plan

6b **Appendix 2 - Current Premises licenses** (*Pages 45 - 58*)

- Appendix 2 – copies of Licences LN8223 & LN42197

6c **Appendices 3, 3a & 3b - Representations and Maps** (*Pages 59 - 66*)

- Appendix 3 – Relevant Representations
- Appendix 3a – Map detailing location of representations
- Appendix 3b – Location Plan of Premises

6d **Appendices 4, 4a and 4b - Representations** (*Pages 67 - 90*)

- Appendix 4 – Further correspondence with applicant
- Appendix 4a – Responses from representations
- Appendix 4b – Removal of 'Film Outdoors'

This page is intentionally left blank

LICENSING COMMITTEE

PROCEDURAL RULES FOR THE HEARING OF LICENSING ACT 2003 APPLICATIONS

1 Purpose

- 1.1 These rules have been prepared to facilitate proper consideration of licence applications, made under the Licensing Act 2003, by the Licensing Committee and its Sub Committees.
- 1.2 The rules set out a framework for how applications are to be heard and explain the role of the participants at the Hearing.

2 Definitions

- 2.1 The following definitions describe the participants at and the subject matter of a Hearing:

“Applicant” means the person who has submitted an Application for consideration by the Committee.

“Applicant’s Premises” means premises subject to the Application.

“Applicant’s Representative” means a person attending a Hearing to assist or represent an Applicant including a lawyer.

“Application” means an application for the Grant/Variation/Transfer/Review and any other decision to be made by the Committee/Sub-Committee in respect of a Licence.

“Chairperson” means the Member who is the Chairperson of the Committee for the particular Hearing.

“Committee” means the Council’s Licensing Committee and includes any Sub Committee of the Licensing Committee.

“Committee Lawyer” means the Council’s Lawyer (including an external Lawyer instructed by the Council’s Legal & Democratic Services Manager) who is present at a Hearing to advise the Chairperson and the Members.

“Committee Manager” means the Council’s Officer who is present at a Hearing to take minutes.

“Committee Report” means the Licensing Officer’s written report to the Committee concerning an Application, a copy of which has been previously made available to the Applicant or their Representative, a Responsible Authority or their Representative or any person who has made a Relevant Representation or their Representative.

“Hearing” means a meeting of the Committee at which an Application is considered and includes virtual hearings.

“**Licence**” means a Licence which the Committee has the power or duty inter alia to grant, transfer, suspend or revoke.

“**Licensing Officer**” means the Council’s Licensing Officer(s) who is/are present at a Hearing to present reports in respect of an Application and to give technical advice in respect of an Application to the Committee when requested.

“**Licensing Authority**” the Council in whose geographical area the subject matter of the Application relates to, and includes the Council’s Licensing Committee, any Sub Committee of the Licensing Committee and a Licensing Officer.

“**Member**” means a Member who is a Member of the Committee that is considering an Application.

“**Person making a Relevant Representation**” means a person who is present at a Hearing to make representations in respect of an Application and includes any person who is present to assist or make representations on behalf of that person including a Lawyer.

“**Responsible Authority**” means a person who is present at a Hearing to make representations in respect of an Application in their capacity as Responsible Authority and includes any person who is present to assist or make representations on behalf of the Responsible Authority including a Lawyer.

3 Key Principles

- 3.1 The principles of ‘natural justice’, and Article 6 ‘Right to a Fair Trial’, which is one of the Convention Rights in the Human Rights Act 1998, require that there is a fair Hearing of Applications.
- 3.2 Natural justice is an umbrella term for the legal standards of basic fairness. This will include that:
 - 3.2.1 the Applicant has an opportunity to make representations before a decision is made;
 - 3.2.2 those making representations have an opportunity to voice their representations before a decision is made;
 - 3.2.3 the Applicant has an adequate opportunity to consider and respond to any submissions made by a Responsible Authority/Authorities and/or any person/s who have made a Relevant Representation;
 - 3.2.4 the Committee does not exclude an Applicant from a Hearing in order to consider submissions from a Responsible Authority/Authorities and/or any person/s who have made a Relevant Representation.
- 3.3 It is also fundamental that there is an orderly presentation of submissions at a Hearing so that the relevant issues are properly understood, evidence is tested and that oral statements made at the Hearing are accurately recorded.

- 3.4 Ultimately the Chairperson determines the application of these rules, having regard to any submissions being made by those present and in particular the Committee Lawyer.

4 The Hearing

- 4.1 The Hearing shall take place as a virtual hearing via Microsoft Teams. Those who are a party to the hearing will be invited to attend the virtual hearing by an email link and members of the public will be able to watch the hearing as it takes place being streamed to the internet or watch the hearing at a later date.

4.1.1 The Committee may exclude the public from all or part of the Hearing where it considers it to be in the public interest to do so and, in accordance with the Local Government (Access to Information) Act 1985, as amended. Public includes a party and any person assisting or representing a party.

4.1.2 The Committee may require any person attending or taking part in the virtual Hearing who, in its opinion, is behaving in a disruptive manner, to leave the Hearing and may:

- A refuse to permit them to return to the virtual Hearing;
- B permit them to return to take part in the virtual Hearing only on such conditions as the Committee may specify;
- C in the event that a person is required to leave a Hearing that person may, before the end of the Hearing, submit to the Committee by email any information which they would have given orally.

4.2 Prior to the Hearing commencing, the Chairperson shall advise the parties of the procedure it proposes to follow at the Hearing.

4.3 Where a party has previously requested permission for a person(s), other than their representative, to appear at the Hearing then the Committee shall consider whether to permit that request.

4.4 The Committee will allow the parties an equal maximum period of time in which to exercise their rights.

4.5 This equal maximum time may have been notified in advance of the Hearing;

4.6 Where there are a number of people who have attended the Hearing to make the same representation then the Committee would normally require that a spokesperson be appointed by them to make the representations on behalf of all of those who have made Relevant Representations.

5 Presentation of Submissions

5.1 The Chairperson will introduce the Application.

5.2 In the event that the Licensing Authority has given notice to a party requiring clarification on a point(s) then that party shall respond to the points raised by the Licensing Authority.

- 5.3 Submissions shall be made in the following order unless the Chairperson directs otherwise:
- 5.3.1 The Licensing Officer will orally present the Committee Report and will in particular advise the Committee as to:
- A the options available to it;
 - B the considerations that are relevant in reaching its decision.
- 5.3.2 The Applicant (or the Applicant's Representative) will orally present its submission which may include:
- A presenting their case in accordance with the papers, which will have been circulated with Agenda papers;
 - B confirming key information and answer pertinent questions; and
 - C calling witnesses in support of the Application (see paragraph 4.3).
- 5.3.3 A Responsible Authority/Authorities and/or any person/s who have made a Relevant Representation will orally present their representations in turn which shall include:
- A the grounds of the representation to the Application; and
 - B any condition(s) that the Responsible Authority/Authorities and/or any person/s who have made a Relevant Representation would be happy to have the Application granted subject to which would cause the representation to be withdrawn.

6 Questioning of Submissions

- 6.1 The Chairperson will regulate the order in which questions are asked by Members.
- 6.2 The Chairperson and Members, voiced through the Chairperson, may question any party following the completion of their submission.
- 6.3 The Chairperson will normally permit the Applicant, a Responsible Authority/Authorities or any person/s who have made a Relevant Representation to ask questions through them of the other parties.
- 6.4 The Chairperson may direct that questions which are not relevant to the Application or one of the four Licensing Objectives are not formally put or answered.

7 Documentation

- 7.1 No party shall present new documentation to the Committee at the Hearing other than with the consent of all of the other parties. This does not preclude the Licensing Officer from correcting errors, providing updated information or an extract from a local map showing the Applicant's Premises in the context of the surrounding premises and any person/s who have made a Relevant Representation. If any party is granted permission

to present supplementary papers at the Hearing they shall provide this by email at the direction of the Chairperson.

8 Intervention

The Chairperson shall permit the following interventions at any point in the Hearing:

- 8.1 The Committee Lawyer to advise the Committee on issues of law, procedure and relevant considerations on decision making. If necessary, the Chairperson may require the Committee, the Committee Lawyer and the Committee Manager to leave the Hearing so that advice can be given.
- 8.2 The Committee Manager to advise the Committee on procedure generally, or to request that statements made are repeated for reasons of clarity and so that they can be properly recorded.
- 8.3 The Licensing Officer to seek to clarify statements that have been made in light of information held on their file.

9 Failure of Parties to Attend Hearing

- 9.1 If a party has informed the Licensing Authority that it does not intend to attend or be represented at a Hearing, the Hearing may proceed in its absence.
- 9.2 If a party has not indicated that it does not intend to attend or take part or be represented at a Hearing and fails to attend or be represented at the Hearing then the Licensing Authority may:
 - 9.2.1 where it considers it be necessary in the public interest, adjourn the Hearing to a specified date; or
 - 9.2.2 hold the Hearing in the party's absence.
- 9.3 Where the Licensing Authority holds a Hearing in the absence of a party, it shall consider at the Hearing the application, representations or notice made by that party.

10 Closing Submissions

- 10.1 The Chairperson shall allow first, the Responsible Authority/Authorities and any person/s who have made a Relevant Representation to make a closing oral submission(s) and secondly invite the Applicant or the Applicant's Representative an opportunity to make an oral closing submission in support of the Application.

11 Decision

- 11.1 The Committee, the Committee Lawyer and the Committee Manager, shall retire from the public meeting so that the decision may be considered in private, and to consider any legal issues raised by the Members. At this point the Chairperson will give an indication of the time that the meeting will resume for the announcement of the decision and all parties to the hearing will be asked to indicate if they intend to return for the announcement of the decision.

- 11.2 The decision, of the Committee shall be communicated orally by the Chairperson to the parties present at the virtual hearing after the Committee has deliberated in private on the Application.
- 11.3 The full decision notice shall be published on the Council's website within 5 working days of the hearing.

Hearing Procedure Summary

1. The Democratic Services Officer will request nominations for a Chairman for the Hearing.
2. The Chairperson welcomes all those present and introduces the Application.
3. The Chairperson introduces the members of the Sub Committee and invites all parties present (Applicant, Responsible Authority/Authorities, any person/s who have made a Relevant Representation and Council Officers) to introduce themselves.
4. The Chairperson outlines the Hearing Procedure as set out in the Agenda, makes any relevant announcements and asks for any declarations of interest.
5. The Licensing Officer is asked to present their Committee Report.
6. The Applicant/their representative is invited to address the Sub Committee in support of their application.
7. Questions to the Applicant by Members of the Sub Committee.
8. Questions to the Applicant by Responsible Authority/Authorities and/or any person/s who have made a Relevant Representation which are to be directed through the Chairperson.
9. Any Responsible Authority/Authorities and/or any person/s who have made a Relevant Representation are invited to address the Sub Committee in support of their representations.
10. Questions to the Responsible Authorities/those who have made a Relevant Representation by Members of the Sub Committee.
11. Questions to the Responsible Authorities/those who have made a Relevant Representation by the Applicant, which are to be directed through the Chairperson.
12. Closing submissions by those Parties who have made a Relevant Representation in reverse order.
13. Closing submissions by the Applicant.
14. Sub Committee retires with the Committee Lawyer and Committee Manager to consider its decision.
15. Sub Committee returns, and the Lawyer gives a summary of any legal advice that may have been given to the Sub Committee.
16. The Chairperson either gives the decision with reasons or advises that it will be released in writing with reasons within the statutory time limits (5 working days).

This page is intentionally left blank

WILTSHIRE COUNCIL

SOUTHERN AREA LICENSING SUB COMMITTEE

13th April 2021

Application for a Variation of a Premises Licence; Green Hill Farm Caravan and Campsite, New Road, Landford SP5 2AZ

1. Purpose of Report

- 1.1 To determine an application for a variation of a Premises Licence in respect of Green Hill Farm Caravan and Campsite, New Road, Landford made by Lovat Parks LTD .

2. Background Information

- 2.1 An application for a variation of a Premises Licence in respect of Green Hill Farm Caravan and Campsite has been made by Lovat Parks LTD for which five relevant representation has been received.
- 2.2 Wiltshire Council (as the Licensing Authority) must hold a hearing to consider the application having regard to the representations. In accordance with Section 35(3) of The Licensing Act 2003 the Licensing Sub Committee is required to take such of the steps listed in 2.4 below as it considers necessary for the promotion of the licensing objectives. In considering the application and the relevant representations, the Sub Committee must also have regard to relevant Government guidance and the Council's Licensing Policy.
- 2.3 The licensing objectives are:
- i) The Prevention of Crime and Disorder;
 - ii) Public Safety;
 - iii) The Prevention of Public Nuisance; and
 - iv) The Protection of Children from Harm.
- 2.4 Such steps are:
- i) To grant the licence as applied for.
 - ii) To modify the conditions of the licence.
 - iii) To reject the whole or part of the application.
- 2.5 On the 12th February an application for a variation to the premises licence was received and accepted as a valid application.

2.6 The details of the variation applied for, are summarised below:

- Consolidate two premises licenses in to one LN/8223 and LN/42197
- Extend the licensable area
- Extend current alcohol trading hours
- Include the addition of Film Indoor

A copy of the application form including the updated plan is attached as **Appendix 1**.

Since 27/02/2014 (LN/08223) and 01/06/2009 (LN/42197) the premises have benefited from a premises licence issued under the Licensing Act 2003. The current licences authorises the following:

Licensing Activities	Hours
Green Hill Farm Reception Shop (LN/42197) <ul style="list-style-type: none"> - Alcohol OFF Sales - Hours open to public 	Sunday 10:00hrs – 16:00hrs Monday – Saturday 09:00hrs – 18:00hrs
Green Hill Farm Caravan and Campsite (LN/08223) <ul style="list-style-type: none"> - Alcohol ON Sales - Hours open to public 	Sunday – Saturday 12:00hrs – 23:00hrs Seasonal Variations: Sales will only take place from 1st March to 31st October and on New Year's Eve. Non Standard Timings New Year's Eve 16:00hrs to 01:00hrs

The Current premises licences including the plans are attached as **Appendix 2**.

Attached as **Appendix 3B** is a location plan of the premises.

Details of other licenced premises in the vicinity of the area are as follows:

Premises	Licensable Activity	Hours (Non standard times not shown)
The Lamb Inn Forest Road Nomansland SP5 2BP (approx. 1.4 miles)	ON and OFF Sales Alcohol	Sunday – Wednesday 08:00hrs – 00:00hrs Thursday – Saturday 08:00hrs – 02:00hrs
	Late Night Refreshment	Sunday – Wednesday 23:00hrs – 00:00hrs Thursday – Saturday 23:00 – 02:00hrs
	Exhibit of Film indoors	Sunday – Saturday 08:00hrs – 23:00hrs

	Live Music	Sunday – Thursday 08:00hrs – 23:00hrs Friday – Saturday 08:00hrs – 00:00hrs
	Indoor Sports Events	Sunday – Wednesday 08:00hrs – 00:00 Thursday – Saturday 08:00hrs – 02:00hrs
	Recorded Music	Sunday – Thursday 08:00hrs – 23:59hrs Friday - Saturday 08:00hrs – 00:00hrs
Landford Stores Lyndhurst Road Landford SP5 2AJ (approx. 1.4 miles)	OFF Sales Alcohol	Sunday 10:00hrs – 22:30 Monday – Saturday 08:00 – 23:00hrs
The Royal Jaipur, Southampton Road, Landford, Salisbury, Wiltshire, SP5 2ED. (approx. 1.3 miles)	ON and OFF Sales Alcohol	Sunday 12:00hrs – 23:30hrs Monday – Saturday 10:00hrs – 00:00hrs

3. Consultation and Representations

- 3.1 The application process requires the application to be advertised, by the Applicant, in a local news publication within 10 working days, starting on the day after the authority receives it and for a public notice (on blue paper) to be posted on the premises. In addition the Licensing Authority advertises the application on its website, for a period of 28 consecutive days, starting the day after the authority receives the application.
- 3.3 During the consultation period 6 relevant representations were received; 6 from local residents. Following a discussion with the applicant 1 local resident withdrew their representation as their concerns had been alleviated.

3.4 Responsible Authorities

No Responsible Authority has made a representation in connection with this application

3.5 Interested Parties

- Mr and Mrs Higgins
- Mrs S Smith
- Ms S Hildon
- Ms G Wilks
- Ms M Lyall

3.6 A summary of the representations made is detailed in the table below:

Representation	Licensing Objective
Mr and Mrs Higgins	The Prevention of a Public Nuisance
Mrs S Smith	The Prevention of a Public Nuisance
Ms S Hildon	The Prevention of a Public Nuisance
Ms G Wilks	The Prevention of a Public Nuisance
Ms M Lyall	The Prevention of a Public Nuisance

3.7 The relevant representations are attached as **Appendix 3**. Attached as **Appendix 3A** is a plan which shows the locations from where representations have been made.

4. **Legal Implications**

4.1 This hearing is governed by the Licensing Act 2003 (Hearings) Regulations. These provide that hearings should be held in public unless the Licensing Authority considers that the public interest in excluding the public outweighs the public interest in the hearing taking place in public.

4.2 The Applicant and all Responsible Authorities and Interested Parties who have made representations have been informed of the date, time and location of the hearing and their right to attend and be represented.

4.3 At the hearing all those Responsible Authorities and Interested Parties who have made representations are entitled to address the Sub Committee and to ask questions of another party, with the consent of the Sub Committee.

5. Officer Recommendations

- 5.1 Officers are not permitted to make a recommendation – the decision is to be reached by the members of the Licensing Sub Committee.

6. Right of Appeal

- 6.1 It should be noted that the Premises Licence Holder, the Responsible Authority(ies) and Interested Parties who have made representations may appeal the decision made by the Licensing Sub Committee to the Magistrates Court. The appeal must be lodged with the Magistrates Court within 21 days of the notification of the decision.
- 6.2 In the event of an appeal being lodged, the decision made by the Licensing Sub Committee remains valid until any appeal is heard and any decision made by the Magistrates Court.
- 6.3 A Responsible Authority or an Interested Party may apply to the Licensing Authority for a Review of a Premises Licence. Whether or not a Review Hearing takes place is in the discretion of the Licensing Authority, but, if requested by an Interested Party will not normally be granted within the first 12 months except for the most compelling circumstances.
-

Report Author: Katherine Edge Public Protection Officer (Licensing)
01225 713559

Date of report: 31st March 2021

Background Papers Used in the Preparation of this Report

- **The Licensing Act 2003**
- **The Licensing Act (Hearings) Regulations 2005**
- **Guidance issued under Section 182 of the Licensing Act 2003**
- **Wiltshire Council Licensing Policy**

Appendices

- 1 Variation Application and Plan**
- 2 Current Premises Licences and Plan LN8223 and LN42197**
- 3 Relevant representations**
 - 3A Map of Representations**
 - 3B Location Plan of Premises**
- 4. Further Correspondence with applicant**
 - 4A Responses from Rep (Doc 1 and 2)**
 - 4B Removal of Outdoor Film from Application**

This page is intentionally left blank

Wiltshire Council

Where everybody matters

Application to vary a premises licence under the Licensing Act 2003

PLEASE READ THE FOLLOWING INSTRUCTIONS FIRST

Before completing this form please read the guidance notes at the end of the form. If you are completing this form by hand please write legibly in block capitals. In all cases ensure that your answers are inside the boxes and written in black ink. Use additional sheets if necessary.

You may wish to keep a copy of the completed form for your records.

I/We LOVIAT PARKS LTD.
(Insert name(s) of applicant)

being the premises licence holder, apply to vary a premises licence under section 34 of the Licensing Act 2003 for the premises described in Part 1 below

Premises licence number	LN 00008223
-------------------------	-------------

Part 1 – Premises Details

Postal address of premises or, if none, Ordnance Survey map reference or description			
GREEN HILL FARM CARAVAN & CAMPSITE NEW ROAD LANDFORD			
Post town	SALISBURY	Postcode	SP5 2AZ
Telephone number at premises (if any)	0333 200 2790		
Non-domestic rateable value of premises	£ 59,900		

Part 2 – Applicant details

Daytime contact telephone number	[REDACTED]		
E-mail address (optional)	[REDACTED]		
Current postal address if different from premises address	LOVIAT PARKS NEWKOP PADDDINGTON 2 EASTBOURNE TERRACE PADDDINGTON LONDON		
Post town	LONDON	Postcode	W2 6LG

Part 3 - Variation

Please tick as appropriate

Do you want the proposed variation to have effect as soon as possible?

Yes

No

If not, from what date do you want the variation to take effect?

DD	MM	YYYY
<input type="text"/>	<input type="text"/>	<input type="text"/>

Do you want the proposed variation to have effect in relation to the introduction of the late night levy? (Please see guidance note 1) Yes No

Please describe briefly the nature of the proposed variation (Please see guidance note 2)

- ① consolidate the 2 licenses to 1 LN 00000 8223.
- ② Extend our current alcohol trading hours.
- ③ Extend the licensable area to comply with Covid-19 social distancing.

If your proposed variation would mean that 5,000 or more people are expected to attend the premises at any one time, please state the number expected to attend:

Part 4 Operating Schedule

Please complete those parts of the Operating Schedule below which would be subject to change if this application to vary is successful.

Provision of regulated entertainment (Please see guidance note 3) Please tick all that apply

- a) plays (if ticking yes, fill in box A)
- b) films (if ticking yes, fill in box B)
- c) indoor sporting events (if ticking yes, fill in box C)
- d) boxing or wrestling entertainment (if ticking yes, fill in box D)
- e) live music (if ticking yes, fill in box E)
- f) recorded music (if ticking yes, fill in box F)
- g) performances of dance (if ticking yes, fill in box G)
- h) anything of a similar description to that falling within (e), (f) or (g) (if ticking yes, fill in box H)

Provision of late night refreshment (if ticking yes, fill in box I)

Supply of alcohol (if ticking yes, fill in box J)

In all cases complete boxes K, L and M

A

Plays Standard days and timings (please read guidance note 8)			<u>Will the performance of a play take place indoors or outdoors or both – please tick</u> (please read guidance note 4)	Indoors	<input type="checkbox"/>
				Outdoors	<input type="checkbox"/>
				Both	<input type="checkbox"/>
Day	Start	Finish			
Mon			<u>Please give further details here</u> (please read guidance note 5)		
Tue					
Wed			<u>State any seasonal variations for performing plays</u> (please read guidance note 6)		
Thur					
Fri			<u>Non standard timings. Where you intend to use the premises for the performance of plays at different times to those listed in the column on the left, please list</u> (please read guidance note 7)		
Sat					
Sun					

B

Films Standard days and timings (please read guidance note 8)			<u>Will the exhibition of films take place indoors or outdoors or both – please tick (please read guidance note 4)</u> Indoors <input type="checkbox"/> Outdoors <input type="checkbox"/> Both <input checked="" type="checkbox"/>
Day	Start	Finish	
Mon	09.00 AM	10.00 PM	
			<u>Please give further details here (please read guidance note 5)</u> WE HAVE A SMALL PROJECTOR AND SCREEN THAT WILL SHOW FILMS WITH NO PAYMENT
Tue	09.00 AM	10.00 PM	
Wed	09.00 AM	10.00 PM	<u>State any seasonal variations for the exhibition of films (please read guidance note 6)</u>
Thur	09.00 AM	10.00 PM	
Fri	09.00 AM	10.00 PM	<u>Non standard timings. Where you intend to use the premises for the exhibition of films at different times to those listed in the column on the left, please list (please read guidance note 7)</u>
Sat	09.00 AM	10.00 PM	
Sun	09.00 AM	10.00 PM	

C

Indoor sporting events Standard days and timings (please read guidance note 8)			<u>Please give further details</u> (please read guidance note 5)
Day	Start	Finish	
Mon			
Tue			<u>State any seasonal variations for indoor sporting events</u> (please read guidance note 6)
Wed			
Thur			<u>Non standard timings. Where you intend to use the premises for indoor sporting events at different times to those listed in the column on the left, please list</u> (please read guidance note 7)
Fri			
Sat			
Sun			

D

Boxing or wrestling entertainments Standard days and timings (please read guidance note 8)			<u>Will the boxing or wrestling entertainment take place indoors or outdoors or both – please tick</u> (please read guidance note 4)	Indoors	<input type="checkbox"/>
				Outdoors	<input type="checkbox"/>
				Both	<input type="checkbox"/>
Day	Start	Finish	<u>Please give further details here</u> (please read guidance note 5)		
Mon					
Tue					
			<u>State any seasonal variations for boxing or wrestling entertainment</u> (please read guidance note 6)		
Wed					
Thur					
			<u>Non standard timings. Where you intend to use the premises for boxing or wrestling entertainment at different times to those listed in the column on the left, please list</u> (please read guidance note 7)		
Fri					
Sat					
Sun					

E

Live music Standard days and timings (please read guidance note 8)			Will the performance of live music take place indoors or outdoors or both – please tick (please read guidance note 4)	Indoors	<input type="checkbox"/>
				Outdoors	<input type="checkbox"/>
				Both	<input type="checkbox"/>
Day	Start	Finish	Please give further details here (please read guidance note 5)		
Mon					
			State any seasonal variations for the performance of live music (please read guidance note 6)		
Tue					
			Non standard timings. Where you intend to use the premises for the performance of live music at different times to those listed in the column on the left, please list (please read guidance note 7)		
Wed					
Thur					
Fri					
Sat					
Sun					

F

Recorded music Standard days and timings (please read guidance note 8)			<u>Will the playing of recorded music take place indoors or outdoors or both – please tick</u> (please read guidance note 4)	Indoors	<input type="checkbox"/>
				Outdoors	<input type="checkbox"/>
				Both	<input type="checkbox"/>
Day	Start	Finish	<u>Please give further details here</u> (please read guidance note 5)		
Mon					
Tue			<u>State any seasonal variations for the playing of recorded music</u> (please read guidance note 6)		
Wed					
Thur			<u>Non standard timings. Where you intend to use the premises for the playing of recorded music at different times to those listed in the column on the left, please list</u> (please read guidance note 7)		
Fri					
Sat					
Sun					

G

Performances of dance Standard days and timings (please read guidance note 8)			<u>Will the performance of dance take place indoors or outdoors or both – please tick</u> (please read guidance note 4)	Indoors	<input type="checkbox"/>
				Outdoors	<input type="checkbox"/>
				Both	<input type="checkbox"/>
Day	Start	Finish	<u>Please give further details here</u> (please read guidance note 5)		
Mon					
Tue			<u>State any seasonal variations for the performance of dance</u> (please read guidance note 6)		
Wed					
Thur			<u>Non standard timings. Where you intend to use the premises for the performance of dance at different times to those listed in the column on the left, please list</u> (please read guidance note 7)		
Fri					
Sat					
Sun					

H

Anything of a similar description to that falling within (e), (f) or (g) Standard days and timings (please read guidance note 8)			Please give a description of the type of entertainment you will be providing		
Day	Start	Finish	<u>Will this entertainment take place indoors or outdoors or both – please tick</u> (please read guidance note 4)	Indoors	<input type="checkbox"/>
Mon				Outdoors	<input type="checkbox"/>
				Both	<input type="checkbox"/>
Tue			<u>Please give further details here</u> (please read guidance note 5)		
Wed					
Thur			<u>State any seasonal variations for entertainment of a similar description to that falling within (e), (f) or (g)</u> (please read guidance note 6)		
Fri					
Sat			<u>Non standard timings. Where you intend to use the premises for the entertainment of a similar description to that falling within (e), (f) or (g) at different times to those listed in the column on the left, please list</u> (please read guidance note 7)		
Sun					

I

Late night refreshment Standard days and timings (please read guidance note 8)			<u>Will the provision of late night refreshment take place indoors or outdoors or both – please tick</u> (please read guidance note 4)		Indoors	<input type="checkbox"/>
					Outdoors	<input type="checkbox"/>
					Both	<input type="checkbox"/>
Day	Start	Finish	<u>Please give further details here</u> (please read guidance note 5)			
Mon						
Tue			<u>State any seasonal variations for the provision of late night refreshment</u> (please read guidance note 6)			
Wed						
Thur			<u>Non standard timings. Where you intend to use the premises for the provision of late night refreshment at different times, to those listed in the column on the left, please list</u> (please read guidance note 7)			
Fri						
Sat						
Sun						

J

Supply of alcohol Standard days and timings (please read guidance note 8)			Will the supply of alcohol be for consumption – please tick (please read guidance note 9)	On the premises	<input type="checkbox"/>
				Off the premises	<input type="checkbox"/>
Day	Start	Finish		Both	<input checked="" type="checkbox"/>
Mon	11.00 AM	23.00 PM	State any seasonal variations for the supply of alcohol (please read guidance note 6)		
Tue	11.00 AM	23.00 PM			
Wed	11.00 AM	23.00 PM			
Thur	11.00 AM	23.00 PM		Non-standard timings. Where you intend to use the premises for the supply of alcohol at different times to those listed in the column on the left, please list (please read guidance note 7)	
Fri	11.00 AM	23.00 PM		The off sales in the park Shop will be.	
Sat	11.00 AM	23.00 PM		11.00am to 21.00 PM MONDAY TO SATURDAY	
Sun	11.00	23.00		12.00 pm to 18.00pm on Sunday.	

K

Please highlight any adult entertainment or services, activities, other entertainment or matters ancillary to the use of the premises that may give rise to concern in respect of children (please read guidance note 10).

L

Hours premises are open to the public Standard days and timings (please read guidance note 8)			State any seasonal variations (please read guidance note 6) Non standard timings. Where you intend the premises to be open to the public at different times from those listed in the column on the left, please list (please read guidance note 7)
Day	Start	Finish	
Mon	0800	2300	
Tue	0800	2300	
Wed	0800	2300	
Thur	0800	2300	
Fri	0800	2300	
Sat	0800	2300	
Sun	0800	2300	

Please identify those conditions currently imposed on the licence which you believe could be removed as a consequence of the proposed variation you are seeking.

M Describe any additional steps you intend to take to promote the four licensing objectives as a result of the proposed variation:

a) General – all four licensing objectives (b, c, d and e) (please read guidance note 11)

* TEAM TRAINED IN LICENSING LAW
* BUILDING SAFETY CHECKS DAILY.
* CHALLENGE 25 & RECORD REFUSALS
* THE AREAS ARE ALL SUPERVISED
* CCTV WILL COVER LICENCED AREAS.

b) The prevention of crime and disorder

* CHALLENGE 25 ADHERED TO
* PROOF OF VAGE SIGNALS DISPLAYED
* SAFETY CHECKS WILL BE PERFORMED DAILY
* SAFETY/FIRE EXITS CLEAR & CHECKED DAILY

c) Public safety

* BUILDINGS HAVE SMOKE ALARMS & EXTINGUISHERS
* FIRE EXIT & BUILDING CHECKS
* CCTV INSTALLED.
* ONLY RESIDENTS WILL BE USING FACILITIES.

d) The prevention of public nuisance

* NO MUSIC AFTER 10.00 PM
* BUILDINGS CLOSED BY 11.00 PM
* UNRULY GUESTS WILL BE REMOVED.

e) The protection of children from harm

* ALL TEAM TRAINED IN SALE OF ALCOHOL
* CHALLENGE 25 ADHERED TO
* ID CARDS OR PASSPORTS REQUIRED AS ID
* REFUSALS RECORDED.

Checklist:

Please tick to indicate agreement

- I have made or enclosed payment of the fee; or
- I have not made or enclosed payment of the fee because this application has been made in relation to the introduction of the late night levy.
- I have sent copies of this application and the plan to responsible authorities and others where applicable.
- I understand that I must now advertise my application.
- I have enclosed the premises licence or relevant part of it or explanation.
- I understand that if I do not comply with the above requirements my application will be rejected.

IT IS AN OFFENCE, UNDER SECTION 158 OF THE LICENSING ACT 2003, TO MAKE A FALSE STATEMENT IN OR IN CONNECTION WITH THIS APPLICATION. THOSE WHO MAKE A FALSE STATEMENT MAY BE LIABLE ON SUMMARY CONVICTION TO A FINE OF ANY AMOUNT.

Part 5 – Signatures (please read guidance note 12)

Signature of applicant (the current premises licence holder) or applicant’s solicitor or other duly authorised agent (please read guidance note 13). **If signing on behalf of the applicant, please state in what capacity.**

Signature	[Redacted]
Date	09.02.21
Capacity	General Manager Lovat Parks.

Where the premises licence is jointly held, signature of 2nd applicant (the current premises licence holder) or 2nd applicant’s solicitor or other authorised agent (please read guidance note 14). **If signing on behalf of the applicant, please state in what capacity.**

Signature	
Date	
Capacity	

Contact name (where not previously given) and address for correspondence associated with this application (please read guidance note 15)			
Post town		Post code	
Telephone number (if any)			

If you would prefer us to correspond with you by e-mail, your e-mail address (optional)

Data Protection: *Wiltshire Council will use this information for the purposes of The Licensing Act 2003 and related purposes. Any member of the public may examine the application form on request. Further information can be found at <http://www.wiltshire.gov.uk/community-safety-privacy-notice>*

You are providing your information to Wiltshire Council, contact details publicprotectionnorth@wiltshire.gov.uk. The Council's Data Protection Officer can be contacted via dataprotection@wiltshire.gov.uk.

Your information is collected for the purpose of processing your licence application as required to fulfil the council's duties under the legislation, statutory or contractual requirement or obligation.

Legislation Context

Licensing Act 2003 for the processing of licensing applications and the prevention of fraud

The information may be shared with Police, Fire Brigade and teams within Wiltshire Council, as statutory consultees, the Home Office to ascertain the right to work and HM Revenue and Customs, at their request, to identify potential fraud.

Notes for Guidance

This application cannot be used to vary the licence so as to extend the period for which the licence has effect or to vary substantially the premises to which it relates. If you wish to make that type of change to the premises licence, you should make a new premises licence application under section 17 of the Licensing Act 2003.

1. You do not have to pay a fee if the only purpose of the variation for which you are applying is to avoid becoming liable for the late night levy
2. Describe the premises. For example, the type of premises, its general situation and layout and any other information which could be relevant to the licensing objectives. Where your application includes off-supplies of alcohol and you intend to provide a place of consumption of these off-supplies of alcohol, you must include a description of where the place will be and its proximity to the premises.
3. In terms of specific regulated entertainments please note that:
 - Plays: no licence is required for performances between 08.00 and 23.00 on any day, provided that the audience does not exceed 500.
 - Films: no licence is required for 'not-for-profit' film exhibition held in community premises between 08.00 and 23.00 on any day provided that the audience does not exceed 500 and the organiser (a) gets consent to the screening from a person who is responsible for the premises; and (b) ensures that each such screening abides by age classification ratings.
 - Indoor sporting events: no licence is required for performances between 08.00 and 23.00 on any day, provided that the audience does not exceed 1000.
 - Boxing or Wrestling Entertainment: no licence is required for a contest, exhibition or display of Greco-Roman wrestling, or freestyle wrestling between 08.00 and 23.00 on any day, provided that the audience does not exceed 1000. Combined fighting sports – defined as a contest, exhibition or display which combines boxing or wrestling with one or more martial arts – are licensable as a boxing or wrestling entertainment rather than an indoor sporting event.
 - Live music: no licence permission is required for:
 - a performance of unamplified live music between 08.00 and 23.00 on any day, on any premises.

- a performance of amplified live music between 08.00 and 23.00 on any day on premises authorised to sell alcohol for consumption on those premises, provided that the audience does not exceed 500.
 - a performance of amplified live music between 08.00 and 23.00 on any day, in a workplace that is not licensed to sell alcohol on those premises, provided that the audience does not exceed 500.
 - a performance of amplified live music between 08.00 and 23.00 on any day, in a church hall, village hall, community hall, or other similar community premises, that is not licensed by a premises licence to sell alcohol, provided that (a) the audience does not exceed 500, and (b) the organiser gets consent for the performance from a person who is responsible for the premises.
 - a performance of amplified live music between 08.00 and 23.00 on any day, at the non-residential premises of (i) a local authority, or (ii) a school, or (iii) a hospital, provided that (a) the audience does not exceed 500, and (b) the organiser gets consent for the performance on the relevant premises from: (i) the local authority concerned, or (ii) the school or (iii) the health care provider for the hospital.
 - Recorded Music: no licence permission is required for:
 - any playing of recorded music between 08.00 and 23.00 on any day on premises authorised to sell alcohol for consumption on those premises, provided that the audience does not exceed 500.
 - any playing of recorded music between 08.00 and 23.00 on any day, in a church hall, village hall, community hall, or other similar community premises, that is not licensed by a premises licence to sell alcohol, provided that (a) the audience does not exceed 500, and (b) the organiser gets consent for the performance from a person who is responsible for the premises.
 - any playing of recorded music between 08.00 and 23.00 on any day, at the non-residential premises of (i) a local authority, or (ii) a school, or (iii) a hospital, provided that (a) the audience does not exceed 500, and (b) the organiser gets consent for the performance on the relevant premises from: (i) the local authority concerned, or (ii) the school proprietor or (iii) the health care provider for the hospital.
 - Dance: no licence is required for performances between 08.00 and 23.00 on any day, provided that the audience does not exceed 500. However, a performance which amounts to adult entertainment remains licensable.
 - Cross activity exemptions: no licence is required between 08.00 and 23.00 on any day, with no limit on audience size for:
 - any entertainment taking place on the premises of the local authority where the entertainment is provided by or on behalf of the local authority;
 - any entertainment taking place on the hospital premises of the health care provider where the entertainment is provided by or on behalf of the health care provider;
 - any entertainment taking place on the premises of the school where the entertainment is provided by or on behalf of the school proprietor; and
 - any entertainment (excluding films and a boxing or wrestling entertainment) taking place at a travelling circus, provided that (a) it takes place within a moveable structure that accommodates the audience, and (b) that the travelling circus has not been located on the same site for more than 28 consecutive days.
4. Where taking place in a building or other structure please tick as appropriate (indoors may include a tent).

5. For example state type of activity to be authorised, if not already stated, and give relevant further details, for example (but not exclusively) whether or not music will be amplified or unamplified.
6. For example (but not exclusively), where the activity will occur on additional days during the summer months.
7. For example (but not exclusively), where you wish the activity to go on longer on a particular day e.g. Christmas Eve.
8. Please give timings in 24 hour clock (e.g. 16.00) and only give details for the days of the week when you intend the premises to be used for the activity.
9. If you wish people to be able to consume alcohol on the premises, please tick 'on the premises'. If you wish people to be able to purchase alcohol to consume away from the premises, please tick 'off the premises'. If you wish people to be able to do both, please tick 'both'.
10. Please give information about anything intended to occur at the premises or ancillary to the use of the premises which may give rise to concern in respect of children regardless of whether you intend children to have access to the premises, for example (but not exclusively) nudity or semi-nudity, films for restricted age groups or the presence of gaming machines.
11. Please list here steps you will take to promote all four licensing objectives together.
12. The application form must be signed.
13. An applicant's agent (for example solicitor) may sign the form on their behalf provided that they have actual authority to do so.
14. Where there is more than one applicant, each of the applicants or their respective agents must sign the application form.
15. This is the address which we shall use to correspond with you about this application.

PLAN OF CABIN

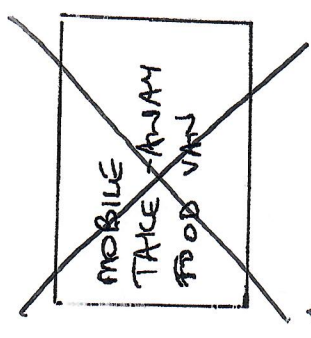
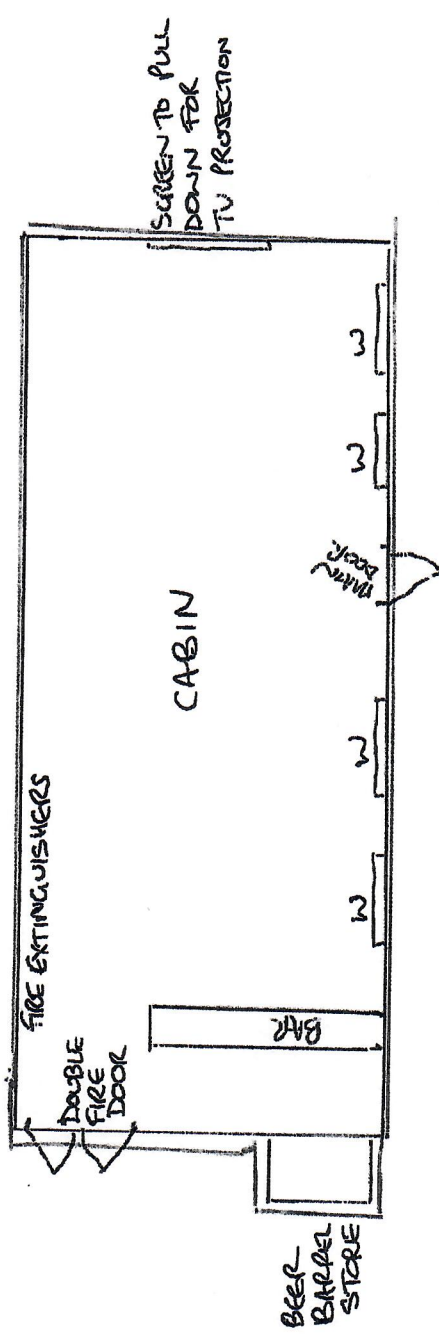
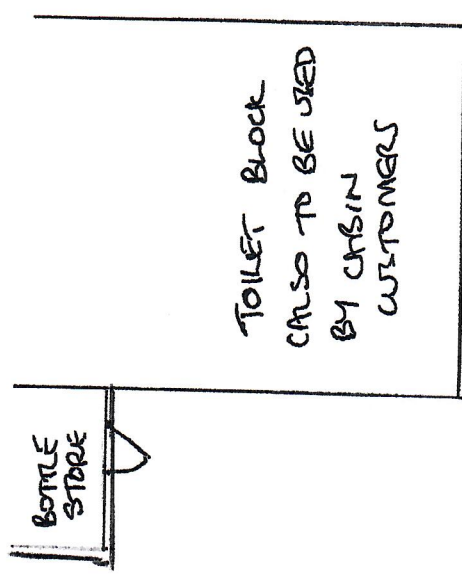

↑ THIS DOES NOT EXIST NOW.
RB
02/02/21.

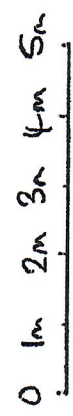

Scale Bar @ 1:100

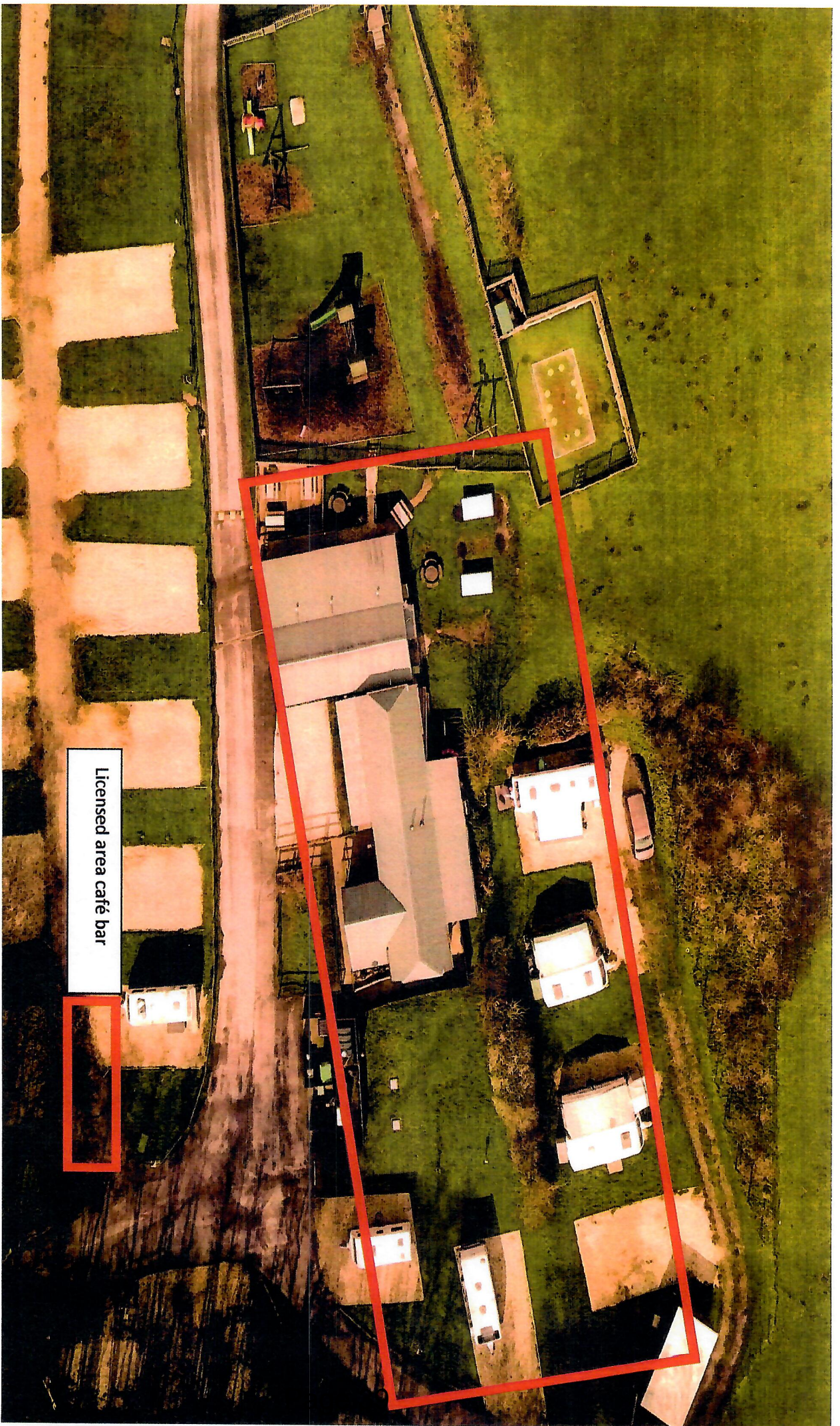

Licensed area café bar

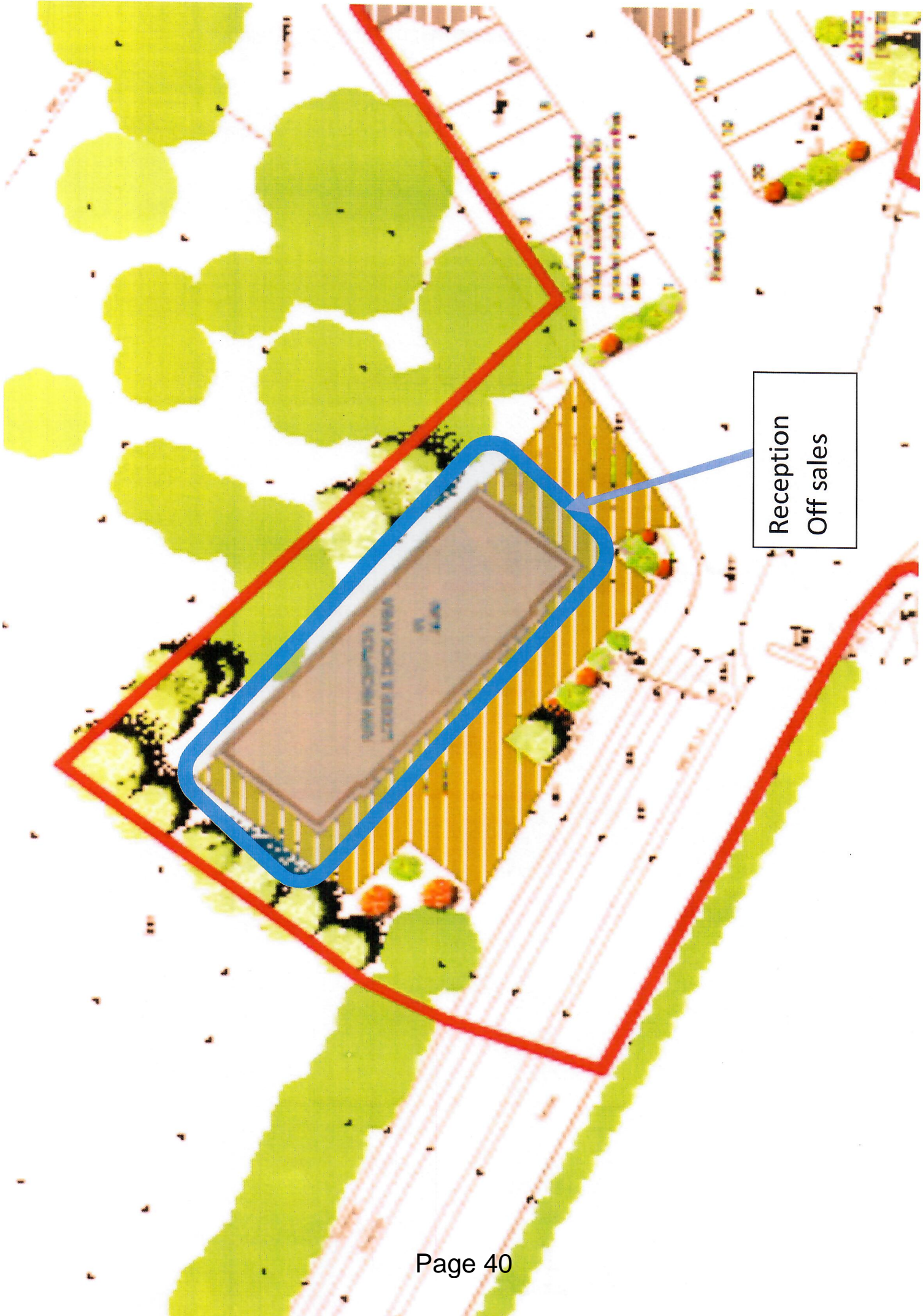

Reception
Off sales

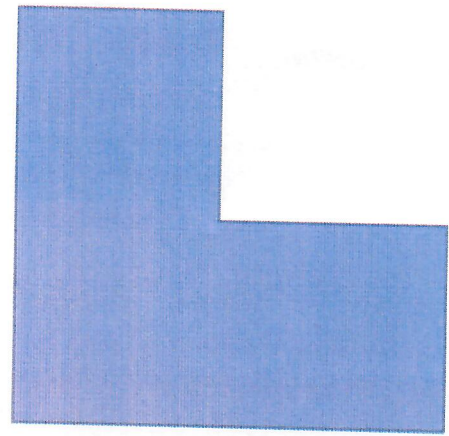

Licensed off sales area.

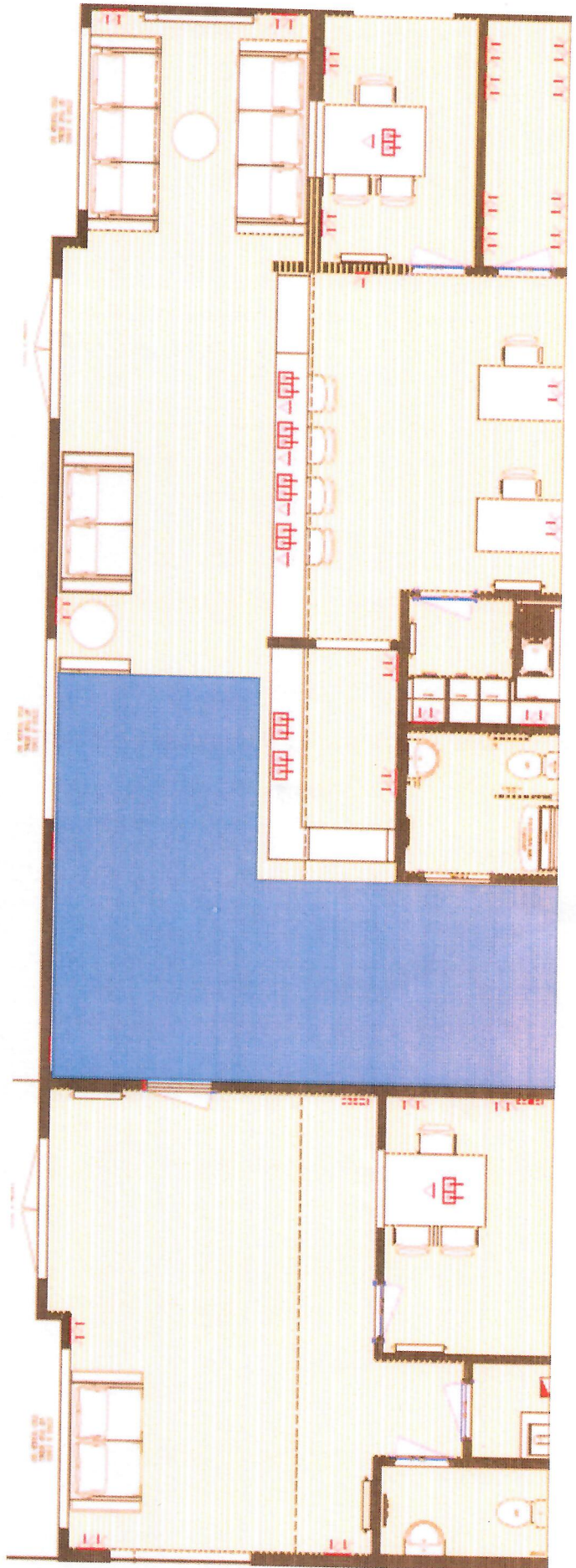

This page is intentionally left blank

- Previous licensable area Shop reception
- Previous licensable area cabin bar

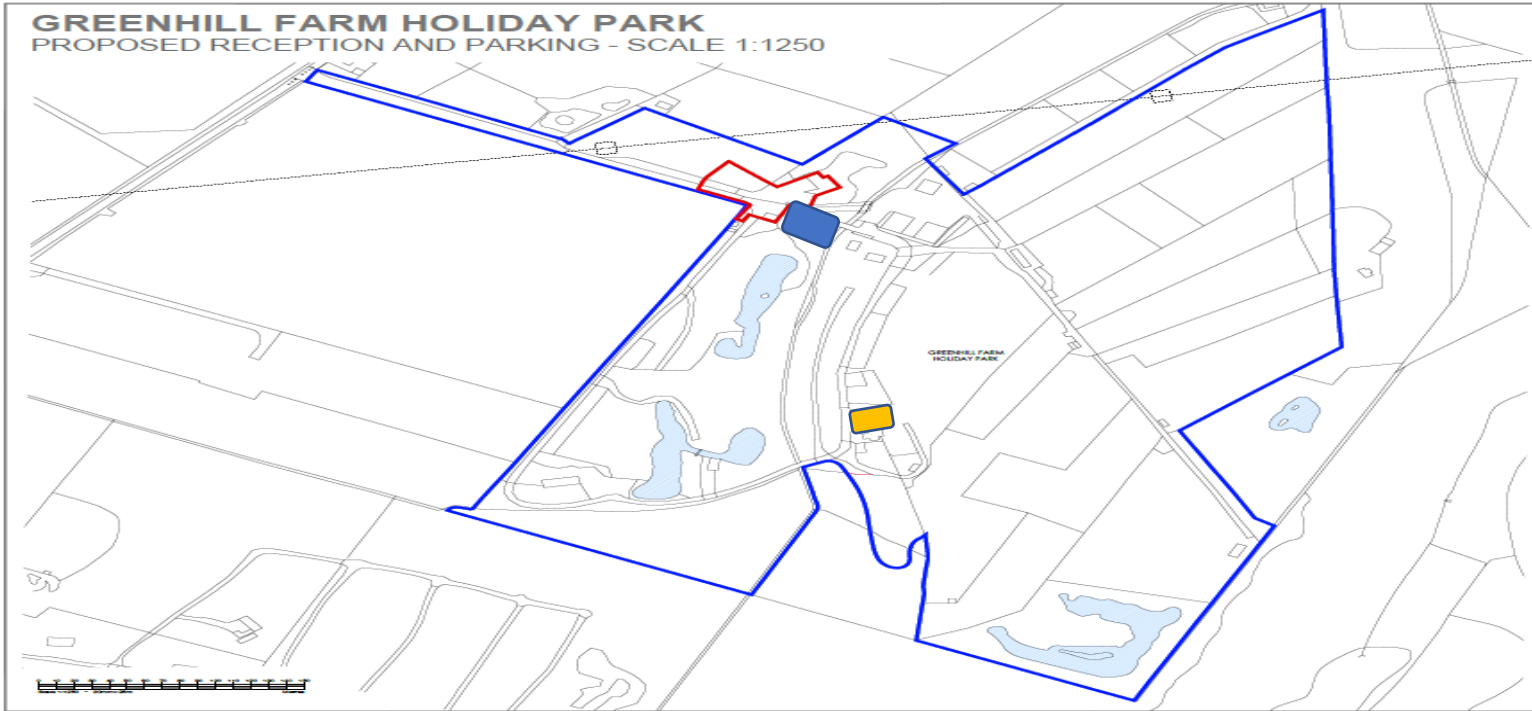

- Requested licensable area for Shop reception.
- Requested licensable area for cabin bar

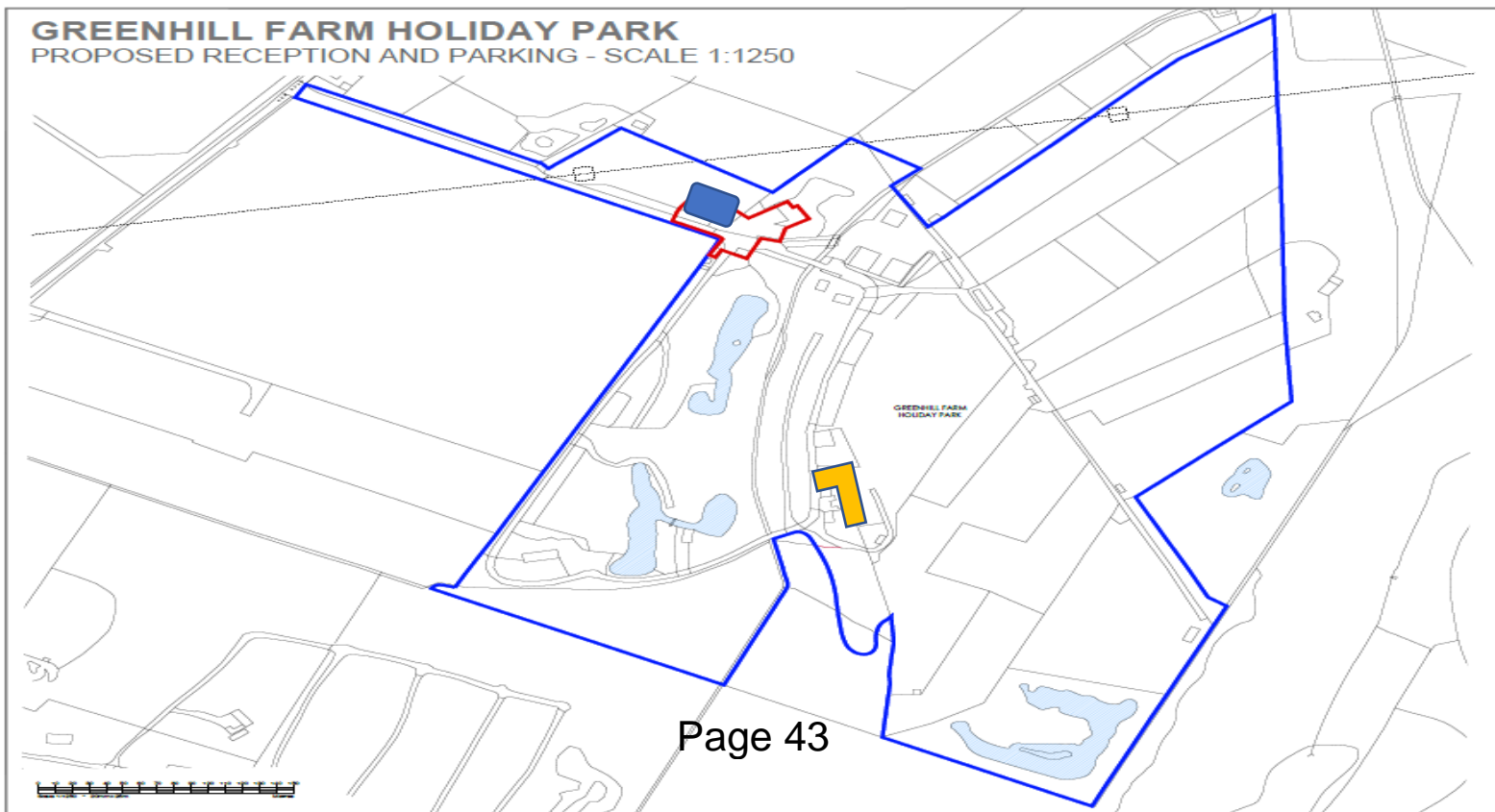

This page is intentionally left blank

Licensing Act 2003
Premises Licence

LN/000008223

ISSUING LOCAL AUTHORITY



PART 1 – PREMISES & LICENCE HOLDER DETAILS

POSTAL ADDRESS OF PREMISES, OR IF NONE, ORDNANCE SURVEY MAP REFERENCE OR DESCRIPTION

Camping And Caravan Site, Green Hill Farm, New Road, Landford, Salisbury, Wiltshire, SP5 2AZ

NAME, (REGISTERED) ADDRESS AND CONTACT DETAILS OF HOLDER OF PREMISES LICENCE

.Lovat Parks Ltd, Wework Paddington,, 2 Eastbourne Terrace,, Paddington,, London, W2 6LG
Tel: 01794 324117 / [REDACTED] Email: enquiries@lovatparks.com

REGISTERED NUMBER OF HOLDER, FOR EXAMPLE COMPANY NUMBER, CHARITY NUMBER

10782220

NAME AND ADDRESS OF DESIGNATED PREMISES SUPERVISOR WHERE THE PREMISES LICENCE AUTHORISES THE SUPPLY OF ALCOHOL

Mr James David Piers Grundy
[REDACTED]

ISSUING AUTHORITY AND PERSONAL LICENCE NUMBER HELD BY DESIGNATED PREMISES SUPERVISOR WHERE THE PREMISES LICENCE AUTHORISES FOR THE SUPPLY OF ALCOHOL

B & NES Council 17/17/02122/LAPER

WHERE THE LICENCE IS TIME LIMITED - THE DATES AND TIMES

Not Applicable

WHERE THE LICENCE AUTHORISES SUPPLIES OF ALCOHOL WHETHER THESE ARE ON AND / OR OFF SUPPLIES

ON Sales only

STATE WHETHER ACCESS TO THE PREMISES BY CHILDREN IS RESTRICTED OR PROHIBITED

Where applicable the provisions of Section 145 of the Licensing Act 2003 apply

PART 2 – LICENSABLE ACTIVITIES & TIMINGS

LICENSABLE ACTIVITIES AUTHORISED BY THE LICENCE						
Licensable activities	Location	Day	Time From	Time To	Time From	Time To
Alcohol Sales	ON Sales	Sunday	12:00	23:00		
		Monday	12:00	23:00		
		Tuesday	12:00	23:00		
		Wednesday	12:00	23:00		
		Thursday	12:00	23:00		
		Friday	12:00	23:00		
		Saturday	12:00	23:00		
Non Standard Timings & Seasonal Variations	Seasonal Variations: Sales will only take place from 1st March to 31st October and on New Year's Eve. Non Standard Timings New Year's Eve 16:00hrs to 01:00hrs					
Hrs premises open to public	The whole premises	Sunday	12:00	23:00		
		Monday	12:00	23:00		
		Tuesday	12:00	23:00		
		Wednesday	12:00	23:00		
		Thursday	12:00	23:00		
		Friday	12:00	23:00		
		Saturday	12:00	23:00		
Non Standard Timings & Seasonal Variations	Seasonal Variations: Sales will only take place from 1st March to 31st October and on New Year's Eve. Non Standard Timings New Year's Eve 16:00hrs to 01:00hrs					

Licence Commencement Date

27th February 2014

Licensing Officer

Last Amendment Date

13th August 2019

Licensing Officer

PLAN OF CABIN

TOILET BLOCK
 ALSO TO BE USED
 BY CABIN
 CUSTOMERS

BOTTLE
 STORE

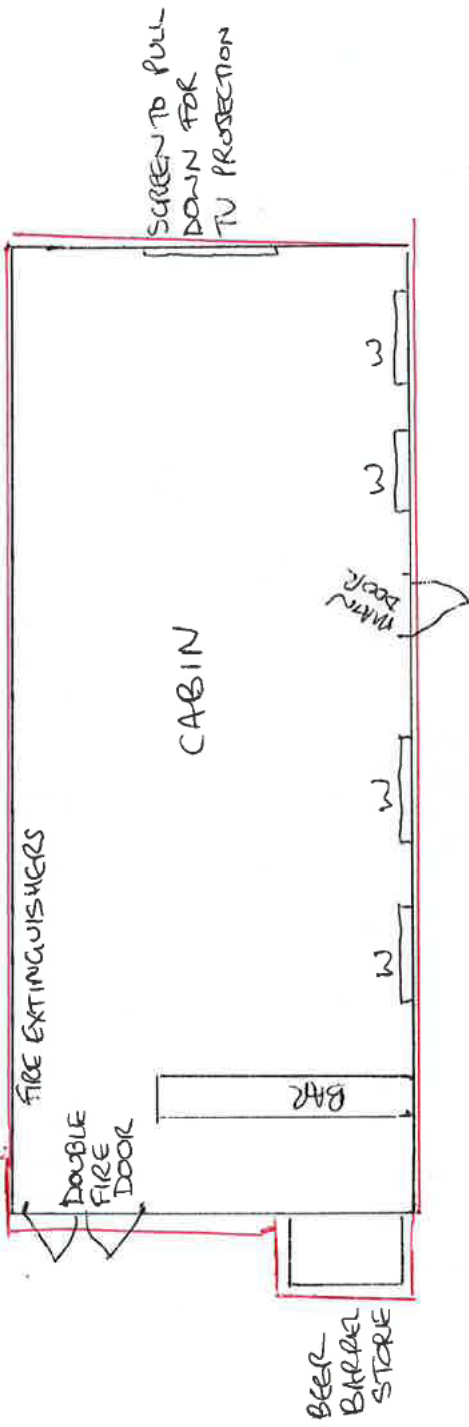

MOBILE
 TAKE-AWAY
 FOOD VAN

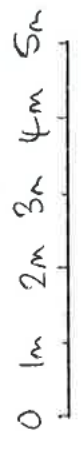

Scale bar @ 1:100



To Rally Fields
and Forest

Recreation Field

Horseshoe Lake
DEEP WATER
To Golden
Meadow

Dog Walk

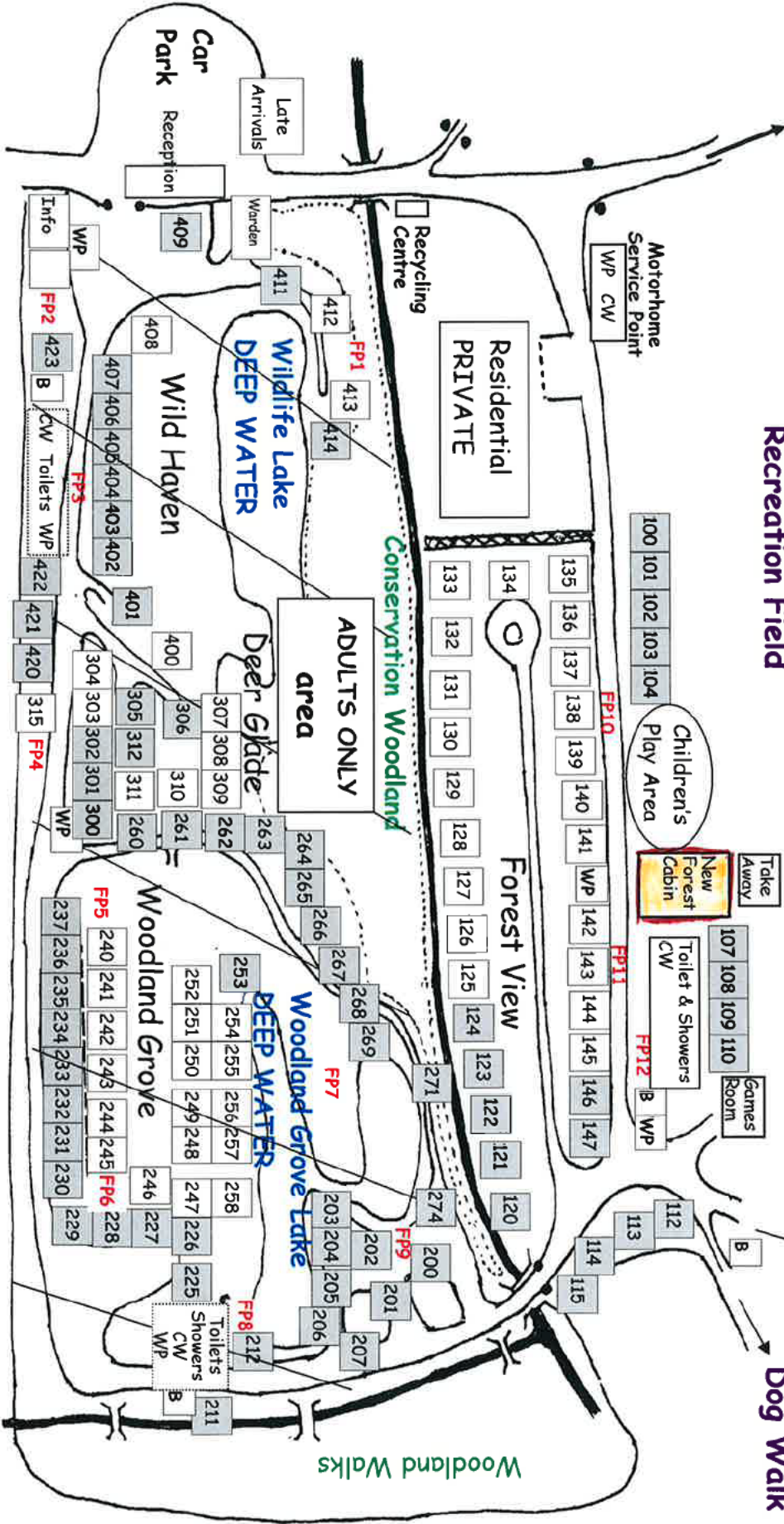

- Key**
- CW=chemical waste
 - WP = water point
 - FP = fire point
 - B = bin point

999 = Handstanding pitch
999 = Grass pitch

not to scale
Approx scale 1:1000



This page is intentionally left blank

ISSUING LOCAL AUTHORITY



PART 1 – PREMISES & LICENCE HOLDER DETAILS

POSTAL ADDRESS OF PREMISES, OR IF NONE, ORDNANCE SURVEY MAP REFERENCE OR DESCRIPTION

Green Hill Farm Reception Shop, Land At Chilla, New Road, Landford, Wiltshire

NAME, (REGISTERED) ADDRESS AND CONTACT DETAILS OF HOLDER OF PREMISES LICENCE

Lovat Parks Ltd,
Wework Paddington, 2 Eastbourne Terrace,, Paddington, London, W2 6LG
Tel: 01794 324117 Email: enquiries@lovatparks.com

REGISTERED NUMBER OF HOLDER, FOR EXAMPLE COMPANY NUMBER, CHARITY NUMBER

10782220

NAME AND ADDRESS OF DESIGNATED PREMISES SUPERVISOR WHERE THE PREMISES LICENCE AUTHORISES THE SUPPLY OF ALCOHOL

Ross Ian Birkett
[REDACTED]

ISSUING AUTHORITY AND PERSONAL LICENCE NUMBER HELD BY DESIGNATED PREMISES SUPERVISOR WHERE THE PREMISES LICENCE AUTHORISES FOR THE SUPPLY OF ALCOHOL

Great Yarmouth Borough Council PA0800

WHERE THE LICENCE IS TIME LIMITED - THE DATES AND TIMES

Not Applicable

WHERE THE LICENCE AUTHORISES SUPPLIES OF ALCOHOL WHETHER THESE ARE ON AND / OR OFF SUPPLIES

OFF Sales

STATE WHETHER ACCESS TO THE PREMISES BY CHILDREN IS RESTRICTED OR PROHIBITED

Where applicable the provisions of Section 145 of the Licensing Act 2003 apply

PART 2 – LICENSABLE ACTIVITIES & TIMINGS

LICENSABLE ACTIVITIES AUTHORISED BY THE LICENCE						
Licensable activities	Location	Day	Time From	Time To	Time From	Time To
Alcohol Sales	OFF Sales	Sunday	10:00	16:00		
		Monday	09:00	18:00		
		Tuesday	09:00	18:00		
		Wednesday	09:00	18:00		
		Thursday	09:00	18:00		
		Friday	09:00	18:00		
		Saturday	09:00	18:00		
Non-Standard Timings & Seasonal Variations						
Hrs premises open to public	Whole Premises	Sunday	10:00	16:00		
		Monday	09:00	18:00		
		Tuesday	09:00	18:00		
		Wednesday	09:00	18:00		
		Thursday	09:00	18:00		
		Friday	09:00	18:00		
		Saturday	09:00	18:00		
Non-Standard Timings & Seasonal Variations						

Licence Commencement Date

1st June 2009

Licensing Officer

Last Amendment Date

Licensing Officer

ANNEX 1 - MANDATORY CONDITIONS

Supply of Alcohol

1. Where this Licence authorises the supply of alcohol:

No supply of alcohol may be made under this licence:

- (a) At a time when there is no Designated Premises Supervisor in respect of the Premises Licence.
- (b) At a time when the Designated Premises Supervisor does not hold a Personal Licence or his Personal Licence is suspended.

Every retail sale or supply of alcohol made under this licence must be made or authorised by a person who holds a Personal Licence.

Exhibition of Films

1. Where a premises licence authorises the exhibition of films, the licence must include a condition requiring the admission of children to the exhibition of any film to be restricted in accordance with this section.
2. Where the film classification body is specified in the licence, unless subsection (3)(b) applies, admission of children must be restricted in accordance with any recommendation by that body.
3. Where:-
- (a) The film classification body is not specified in the licence, or
 - (b) The relevant licensing authority has notified the holder of the licence that this subsection applies to the film in question; admission of children must be restricted in accordance with any recommendation made by that licensing authority.
4. In this section “children” means any person aged under 18; and “film classification body” means the person or persons designated as the authority under Section 4 of the Video Recordings Act 1984(c39) (authority to determine suitability of video works for classification).

Irresponsible Promotions

1. The responsible person must ensure that staff on relevant premises do not carry out, arrange or participate in any irresponsible promotions in relation to the premises.
2. In this paragraph, an irresponsible promotion means any one or more of the following activities, or substantially similar activities, carried on for the purpose of encouraging the sale or supply of alcohol for consumption on the premises—
- (a) games or other activities which require or encourage, or are designed to require or encourage, individuals to—
 - i. drink a quantity of alcohol within a time limit (other than to drink alcohol sold or supplied on the premises before the cessation of the period in which the responsible person is authorised to sell or supply alcohol), or,
 - ii. drink as much alcohol as possible (whether within a time limit or otherwise);.
 - (b) provision of unlimited or unspecified quantities of alcohol free or for a fixed or discounted fee to the public or to a group defined by a particular characteristic in a manner which carries a significant risk of undermining a licensing objective;

- (c) provision of free or discounted alcohol or any other thing as a prize to encourage or reward the purchase and consumption of alcohol over a period of 24 hours or less in a manner which carries a significant risk of undermining a licensing objective;
- (d) selling or supplying alcohol in association with promotional posters or flyers on, or in the vicinity of, the premises which can reasonably be considered to condone, encourage or glamorise anti-social behaviour or to refer to the effects of drunkenness in any favourable manner;
- (e) dispensing alcohol directly by one person into the mouth of another (other than where that other person is unable to drink without assistance by reason of disability)

Free Tap Water

1. The responsible person must ensure that free potable tap water is provided on request to customers where it is reasonably available. (This means that responsible persons at all premises must ensure customers are provided with potable (drinking) water for free if they ask for it.)

Age Verification Policy

- (a) The premises licence holder or club premises certificate holder must ensure that an age verification policy is adopted in respect of the premises in relation to the sale or supply of alcohol.
- (b) The designated premises supervisor in relation to the premises licence must ensure that the supply of alcohol at the premises is carried on in accordance with the age verification policy.
- (c) The policy must require individuals who appear to the responsible person to be under 18 years of age (or such older age as may be specified in the policy) to produce on request, before being served alcohol, identification bearing their photograph, date of birth and either—
 - i. a holographic mark, or.
 - ii. an ultraviolet feature.

Drink Volume Measures

1. The responsible person shall ensure that:
 - (a) where any of the following alcoholic drinks is sold or supplied for consumption on the premises (other than alcoholic drinks sold or supplied having been made up in advance ready for sale or supply in a securely closed container) it is available to customers in the following measures:
 - i. beer or cider: ½ pint;
 - ii. gin, rum, vodka or whisky: 25 ml or 35 ml; and
 - iii. still wine in a glass: 125 ml.
 - (b) these measures are displayed in a menu, price list or other printed material which is available to customers on the premises; and
 - (c) where a customer does not in relation to a sale of alcohol specify the quantity of alcohol to be sold, the customer is made aware that these measures are available.

Permitted Price

1.
 - (a) A relevant person shall ensure that no alcohol is sold or supplied for consumption on or off the premises for a price which is less than the permitted price.
 - (b) For the purposes of the condition set out in paragraph 1—
 - A. “duty” is to be construed in accordance with the Alcoholic Liquor Duties Act 1979;
 - B. “permitted price” is the price found by applying the formula—

$$P = D + (D \times V)$$
 where—
 - i. P is the permitted price,

- ii. D is the amount of duty chargeable in relation to the alcohol as if the duty were charged on the date of the sale or supply of the alcohol, and
- iii. V is the rate of value added tax chargeable in relation to the alcohol as if the value added tax were charged on the date of the sale or supply of the alcohol;

C. "relevant person" means, in relation to premises in respect of which there is in force a premises licence—

- i. the holder of the premises licence,
- ii. the designated premises supervisor (if any) in respect of such a licence, or
- iii. the personal licence holder who makes or authorises a supply of alcohol under such a licence;

D. "relevant person" means, in relation to premises in respect of which there is in force a club premises certificate, any member or officer of the club present on the premises in a capacity which enables the member or officer to prevent the supply in question; and

E. "value added tax" means value added tax charged in accordance with the Value Added Tax Act 1994.

2. Where the permitted price given by Paragraph B of paragraph 2 would (apart from this paragraph) not be a whole number of pennies, the price given by that sub-paragraph shall be taken to be the price actually given by that sub-paragraph rounded up to the nearest penny.

3.

(1) Sub-paragraph (2) applies where the permitted price given by Paragraph B of paragraph 2 on a day ("the first day") would be different from the permitted price on the next day ("the second day") as a result of a change to the rate of duty or value added tax.

(2) The permitted price which would apply on the first day applies to sales or supplies of alcohol which take place before the expiry of the period of 14 days beginning on the second day.

Door Supervision (except theatres, cinemas, bingo halls and casinos)

1. Where a premises licence includes a condition that at specified times one or more individuals must be at the premises to carry out a security activity, each such individual must:

- (a) be authorised to carry out that activity by a licence granted under the Private Security Industry Act 2001; or
- (b) be entitled to carry out that activity by virtue of section 4 of the Act.

2. But nothing in subsection (1) requires such a condition to be imposed:

- (a) in respect of premises within paragraph 8(3)(a) of Schedule 2 to the Private Security Industry Act 2001 (c12) (premises with premises licences authorising plays or films); or
- (b) in respect of premises in relation to:
 - i. any occasion mentioned in paragraph 8(3)(b) or (c) of that Schedule (premises being used exclusively by club with club premises certificate, under a temporary event notice authorising plays or films or under a gaming licence), or
 - ii. any occasion within paragraph 8(3)(d) of that Schedule (occasions prescribed by regulations under that Act).

3. For the purposes of this section:

- (a) "security activity" means an activity to which paragraph 2(1)(a) of that Schedule applies, and, which is licensable conduct for the purposes of that Act, (see Section 3(2) of that Act) and
- (b) paragraph 8(5) of that Schedule (interpretation of references to an occasion) applies as it applies in relation to paragraph 8 of that Schedule.

ANNEX 2A – CONVERTED CONDITIONS

- None

ANNEX 2B - OPERATING SCHEDULE

PREVENTION OF PUBLIC NUISANCE

- None

PUBLIC SAFETY

- None

PROTECTION OF CHILDREN FROM HARM

- Approved photographic proof of age will be required to be shown by anyone seeking to purchase alcohol who appears to be under 21 years of age
- Alcohol will be displayed for sale out of the reach of children

PREVENTION OF CRIME AND DISORDER

- Alcohol will only be sold to customers staying at the caravan site

ANNEX 3 - CONDITIONS ATTACHED AFTER HEARING

- None

ANNEX 4 - PLANS

Attached Separately

Dated 01.06.2009

PLAN OF RECEPTION / SHOP BUILDING

SCALE 100:1

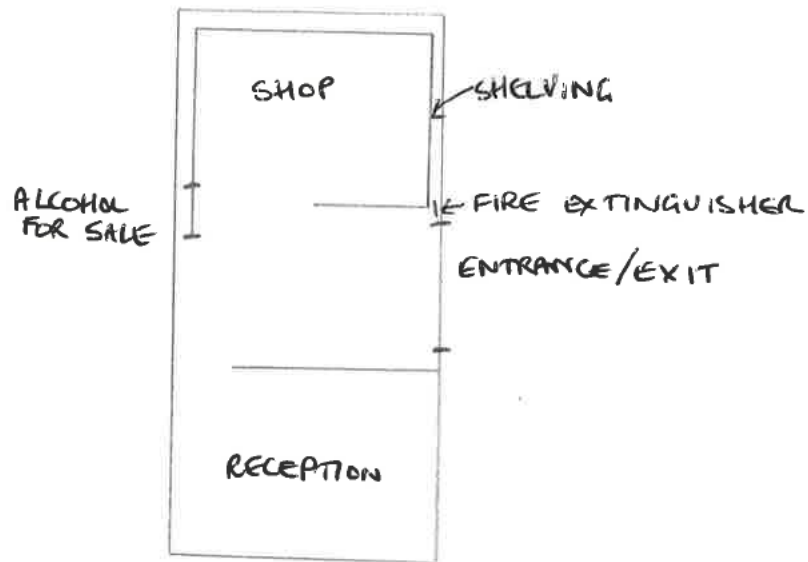

COPY

Certified a true copy

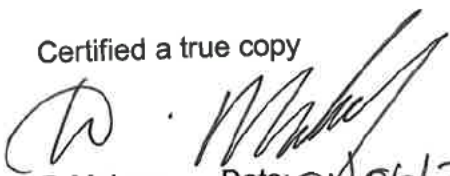
D Mulvey Date: 01/06/2009
Licensing Officer

LN42197

COPY

LICENSING AUTHORITY
CERTIFIED COPY *John Gendall*
DATE 11/3/2014
To Rally Fields
and Forest

GREEN HILL FARM
Caravan & Camping Park

Horseshoe Lake
DEEP WATER
To Golden
Meadow

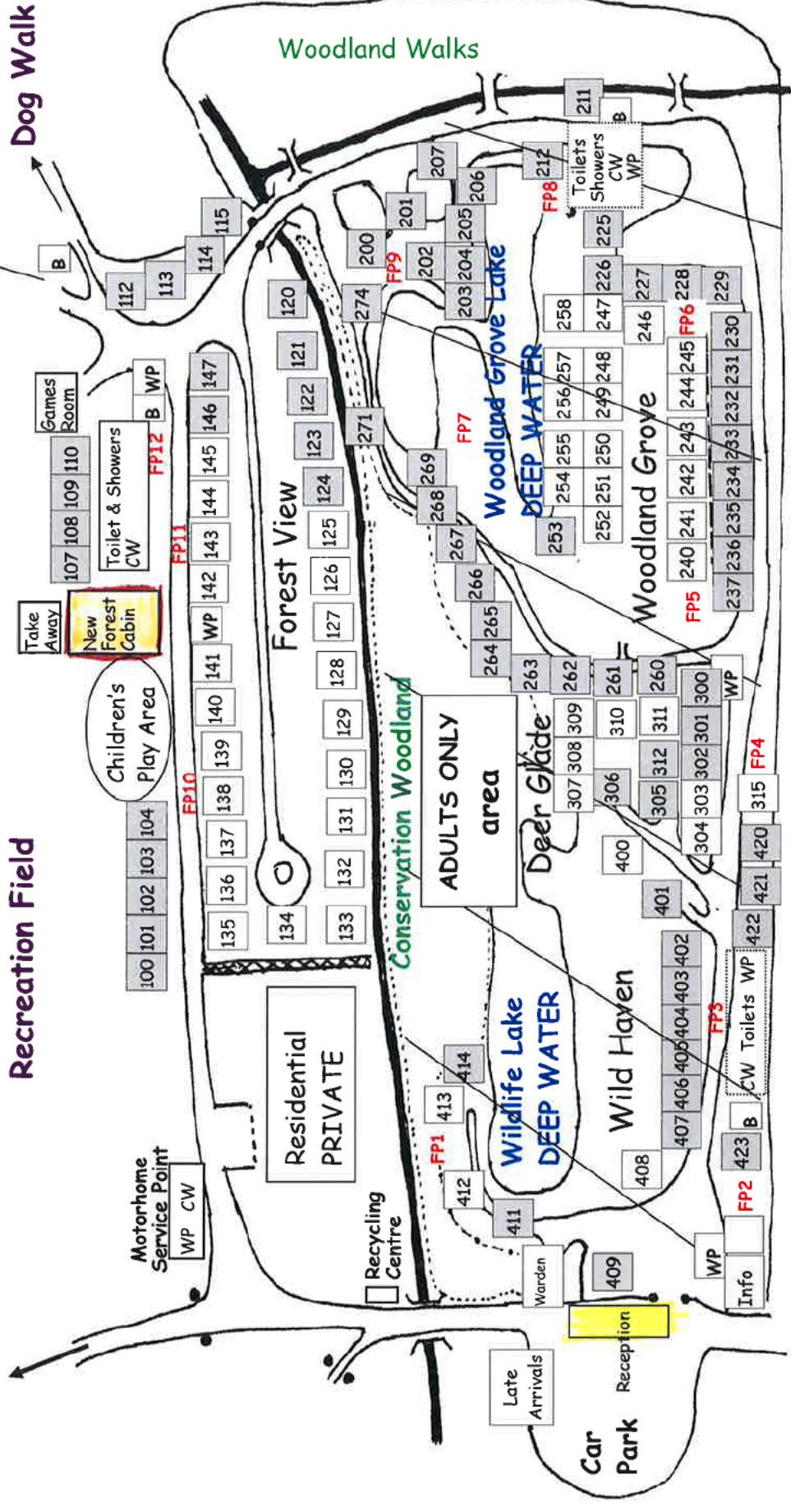

Key
CW=chemical waste
WP = water point
FP = fire point
B = bin point
999 = Handstanding pitch
999 = Grass pitch

not to scale
Approx Scale 1:1000

Representation

1. Mrs Lisa and Mr Richard Higgins,

Forest Springs Farm, New Road, Landford, Salisbury, SP5 2AZ

My family and I live at Forest Springs Farm, New Road, Landford, Salisbury, SP5 2AZ. At the closest point, our boundary is only a matter of 20 - 30 metres or so from the boundary of Green Hill Farm. We are one of a group of residential homes that are within close proximity of Green Hill Farm and we also now (owing to the removal of huge areas of trees and scrub by Lovat Parks) now directly overlook the site and (vice versa) they also have eroded our privacy and at many points along the boundary, now overlook our home.

I would like to raise our concerns regarding the application to vary premises:

1. Noise Pollution: The camp site is applying to extend trading hours to longer hours that we consider to be not in keeping with a quiet, rural, residential area. We consider extending trading hours of the Cabin Bar to 11pm every day (Monday - Sunday), every day of the year (1st January - 31st December) to be antisocial and inconsiderate of the local residential community, many of whom have young children (including us). A bar being open so late in such close proximity to residential homes is undoubtedly going to create extra noise and disruption and will have a direct impact on us given our (and other residents) extremely close proximity to the camp site. We live in a rural area with very little between us and the camp site to dampen noise (very few trees and vegetation due to the land between being open field, and even fewer trees since the camp site have removed those that previously blocked our view of the site). Any noise from the camp site carries incredibly far and is easily audible by us at any point on our property. We have experienced enormous problems with noise emitted by the camp site over the past nearly 12 months, due to the development work - from the vehicles, diggers, lorries, drilling, etc. It has been incredibly stressful especially during long periods of lockdown where we are unable to remove ourselves from our property to escape the noise and whilst I have been attempting to home school my young children with constant machinery / drilling noise easily audible. We also have not had easy access to the usual agencies to whom we could raise concerns during lockdown, which has (combined with other impacts of lockdown) made raising concerns very difficult. We are incredibly concerned that extending the licensing permissions and trading hours will increase the amount of noise pollution that is created by the campsite.
2. First Step towards further development not in keeping with the area: We are concerned about the trustworthiness of Lovat Parks and believe that extending licensing permissions and trading hours will be the first step towards incremental deviation from the original planning application for the development of the camp site and for extending the scope of the site beyond what is reasonable and in keeping for our small community. We have already experienced deviations from the original plans which were approved and a blatant pushing of boundaries (i.e. cutting down of trees and vegetation to such an extent that the site that was previously not visible from New Road is now an obvious eye sore, etc.). We are pursuing these issues separately, however, given this and other examples of blatant disregard for plans and the local residents, we are concerned that approving the variation to licensing will open the door for more development. Landford and New Road, are both a rural, quiet, small community. The camp site that existed previously at Green Hill Farm was run by local residents, unobtrusive and small in scale. Lovat Parks is none of these and we believe they intend to develop the site to the absolute maximum, regardless of the local community.
3. Impact on local businesses: We are concerned for the impact on local business should the trading hours of the bar and shop be extended. Should the trading hours of the Cabin Bar extend, the few local recreation and food businesses in Landford and nearby villages (such as The Lamb Inn in Landford, the Cuckoo near Hamptworth, Mirabelle in Landford), will undoubtedly suffer. These local, often family run businesses, have suffered hugely during the past 12 months of the pandemic and extending trading hours for a large, developed, village of lodges that is run by a non-local 'big business' firm will be incredibly damaging to any chances that these local businesses have of recovering after the pandemic. Previously, visitors to the camp site would naturally turn to the local pubs and restaurants for meals etc. An on-site bar

and shop at the camp site with extended trading hours will provide visitors with far fewer reasons to frequent local pubs and restaurants. Regarding the extended trading hours of the camp site shop, the same principle applies regarding diverting business from local (small, family run) shops - Landford Stores (and post office) and also Nisa Wellow (on the A36). Our family owns the Nisa Wellow and we employ approx. 250 people in and around Hampshire across 5 small convenience stores. We are proud to employ local people and to have sponsored local communities in many ways over the past 20 or so years (we sponsor the Wellow children's football club and have previously sponsored Nomansland Pre-School for several years, as a few of many examples). Whilst only one of our stores (at Wellow) would potentially suffer from extended trading hours at the camp site shop, being experienced in the business, we are all to aware of the damage that it will do to smaller enterprises such as Landford Stores. Regarding our store at Wellow, should we suffer a significant dip in revenue, this may unfortunately equate to reducing staff numbers, which would have a direct impact on the local community as all our employees are local to the stores. I do not believe that the small numbers of staff that the camp site would employ locally would off-set this.

4. Impact on traffic and road safety: Previously, the camp site was seasonal. The season ran, roughly, from April to November. This was roughly in keeping with most of the New Forest and enabled locals to resume a 'normal' life in the off-season period. Lovat Parks had previously assured us that their season would also run from April to November. However, this application to extend premises licencing to every day for the whole year, is completely contrary to their initial claim. It also has the potential to increase traffic flow (on New Road in particular) and on the country lanes in the surrounding villages during off-season. The roads in Landford are frequently used as a 'rat run' from more populous areas to the New Forest. The roads that run almost directly from the end of New Road (on the Forest side; to Nomansland and Bramshaw) are all subject to 'commoning' and frequently have animals walking along them. The number of animals killed by traffic increases exponentially during the holiday season due to the increased non-local traffic. Visitors to camp site will most likely have large camper van- type vehicles, which can cause immense damage to animals. If the season at Green Hill Farm were to extend throughout the year, I have no doubt that the current traffic issues would also increase in line with this. As a point of reference, New Road is regularly subject to locally-run speed traps and speed measuring due to it being a common through road from the A36 for large amounts of traffic. Bramshaw village council in the last few years has put speed control measures in place due to the enormous problem that was being experienced with traffic and speeding. An additional point regarding New Road is that many horse riders use New Road to access the Forest (New Road is home to Landford Common Stud, a large equestrian livery and to local Farriers and the majority of residents own horses). The increase in traffic that extending bar and shop opening hours at the camp site would create would have a detrimental effect on the any horse riders that have to compete with large amounts of traffic, large vehicles and speeding (especially from non-local visitors who are not aware of the area).
5. Finally, we believe that the development of the camp site from an unobtrusive small, rural space for low key camping, to part of a nationwide leisure business, now very much a 'village' of lodges, totally visible from the road (where previously it was not), a source of huge noise pollution (where previously it was not), is not in keeping with maintaining the integrity of our small, rural, local community. We believe that this application to extend the premises licence is a step in the wrong direction.

.....

2. Mrs Sam Smith

Rosebank Cottage, New Road, Landford, SP5 2AZ

Please take this email as objection to the application for variation of licenses at Greenhill Farm Caravan and campsite - New Road, Landford, SP5 2AZ

As a resident of New Road for 10 years and resident of the New Forest for 40 years I raise objection to the application.

The application to consolidate 2 licenses to 1 – LN000008223

Extension to current trading hours – extends the year, as applying to go from seasonal, and also extending hours.

This will bring additional noise – last year is the noisest I have ever known – with noise heard past 23:00 most nights in the summer. – yet they state no noise past 22:00 – blatantly no way of enforcing this – yet they state it as a term of control

They apply to have a license to sell up to 23:00, yet state the building will close at 23:00 – contradiction of application.

Sales now to take place on a Sunday also.

This affects local business pubs and shops – at least 4 local pubs would have benefitted from the previous campers, all within walking distance of camp.

Extending area to comply with Covid 19 social distancing.

This requirement by law will soon be removed, and subsequently extension of area should only be on temporary timescales, extension of this area is not a legal requirement.

Applying to show films outdoors – object under noise and light pollution, as they advertised and held a drive through cinema event last year, - bringing additional noise pollution, lights and cars into an area where they advocate to be surrounded by nature – yet show no consideration as the event was held in a former agriculture field which had no previous camping or camping associated events taking place.

All of this application is for “residents” of the park only and even if I agreed with it, brings nothing to the local community except additional noise and footfall to what should be kept a to a small quiet campsite as in previous years.

.....

3. Stephanie Hildon

The Old Orchard, New Road, Landford SP5 2AZ

I would like to object to the variation of premises licence application made by Greenhill Farm, New Road, Landford, Wiltshire under the above reference/notice ID.

This is a very quiet, dark residential road. With little night-time traffic, no night-time light, and little noise. That's why I chose to live here.

Allowing an extension of licensing hours for this site will encourage noise and late night traffic. Noise travels great distance here because there is none and it will interrupt the quiet enjoyment of my property. There are already established licensed premises within 2 miles walking distance in both directions from the Greenhill farm site, and a 3rd licenced property with year round, long licensing hours is totally unnecessary and will be a public nuisance.

Furthermore, the site encourages visitors - with public events such as drive in movies. I would like to object to this application too. Having visitors on site, with licensed premises for longer hours in winter, then driving home, is a risk to public safety. Walking along this road in the dark is the alternative - but

it is very dangerous as there are no lights and no pavements. This is a school bus route - my children have to walk along the road in the dark in winter and adding cars driving to a licensed premises, with children walking in the dark is a great risk to health and safety.

I look forward to your response. I would welcome the opportunity to make representations at a council meeting.

.....

4. Gemma Wilks
(Awaiting address)

I would like to object to the variation of premises licence application made by Greenhill Farm, New Road, Landford, Wiltshire.

This is a very quiet, dark residential road. With little night-time traffic, no night-time light, and little noise.

Allowing an extension of licensing hours for this site will encourage noise and late night traffic. Noise travels a greater distance here because there is none and it will interrupt the quiet enjoyment of local residents. There are already established licensed premises within 2 miles walking distance in both directions from the Greenhill farm site, and a 3rd licensed property with year round, long licensing hours is totally unnecessary and will be a public nuisance.

Furthermore, the site encourages visitors - with public events such as drive in movies. Having visitors on site, with licensed premises for longer hours in winter, then driving home, is a risk to public safety. Walking along this road in the dark is the alternative - but it is very dangerous as there are no lights and no pavements.

.....

5. Michelle Lyall
Victoria Cottage, New Road, Landford, Salisbury, SP5 2AZ

In relation to the current application for extended drinking hours/license I am writing to express my concern.

Last year we had horrendous litter from this site, with rowdy walkers from the site dropping beer bottles etc. This happened on New Road as well as the open forest that it backs onto.

I have a young child and animals and have had to stop my son cycling due to the increased danger of increased traffic (their last season), and my horse has definitely become more skittish due to the quietness of the area being taken away by numerous machinery felling trees etc.

People becoming drunk and loud put a lot of animals on the forest in danger. I've seen youths try to grab hold of wild ponies, and kick balls etc in their direction.

I'm all for progression, but this area has had more important things turned down in aid of keeping it a rural, quiet, non commercialised environment. The noise pollution is not good for residents, wildlife or pets/recreational horses.

Excuse the ramblings, it just makes people feel that their homes are no longer as they wanted them to be, with such big changes on our doorstep.

Appendix 3A – Map of Representations

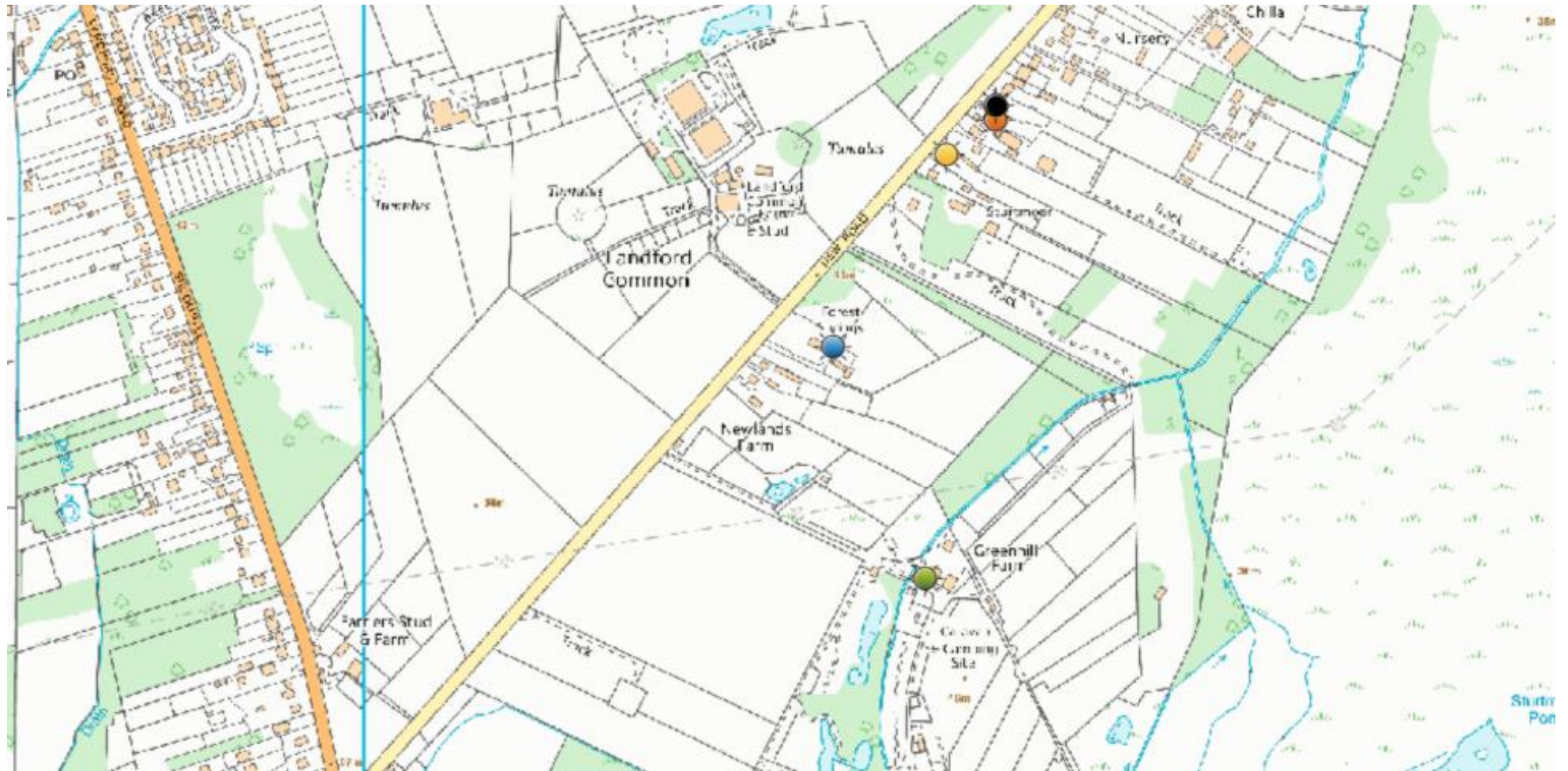

Applicant Green Hill Farm Caravan and Campsite

1. Mr and Mrs Higin - Forest Springs
2. Mrs S Smith - Rosebank Cottage
3. Ms S Hildon - The Old Orchard
4. Ms G Wilks - Boleyn Cottage
5. Ms M Lyall - Victoria Cottage

Appendix 3A – Map of Representations

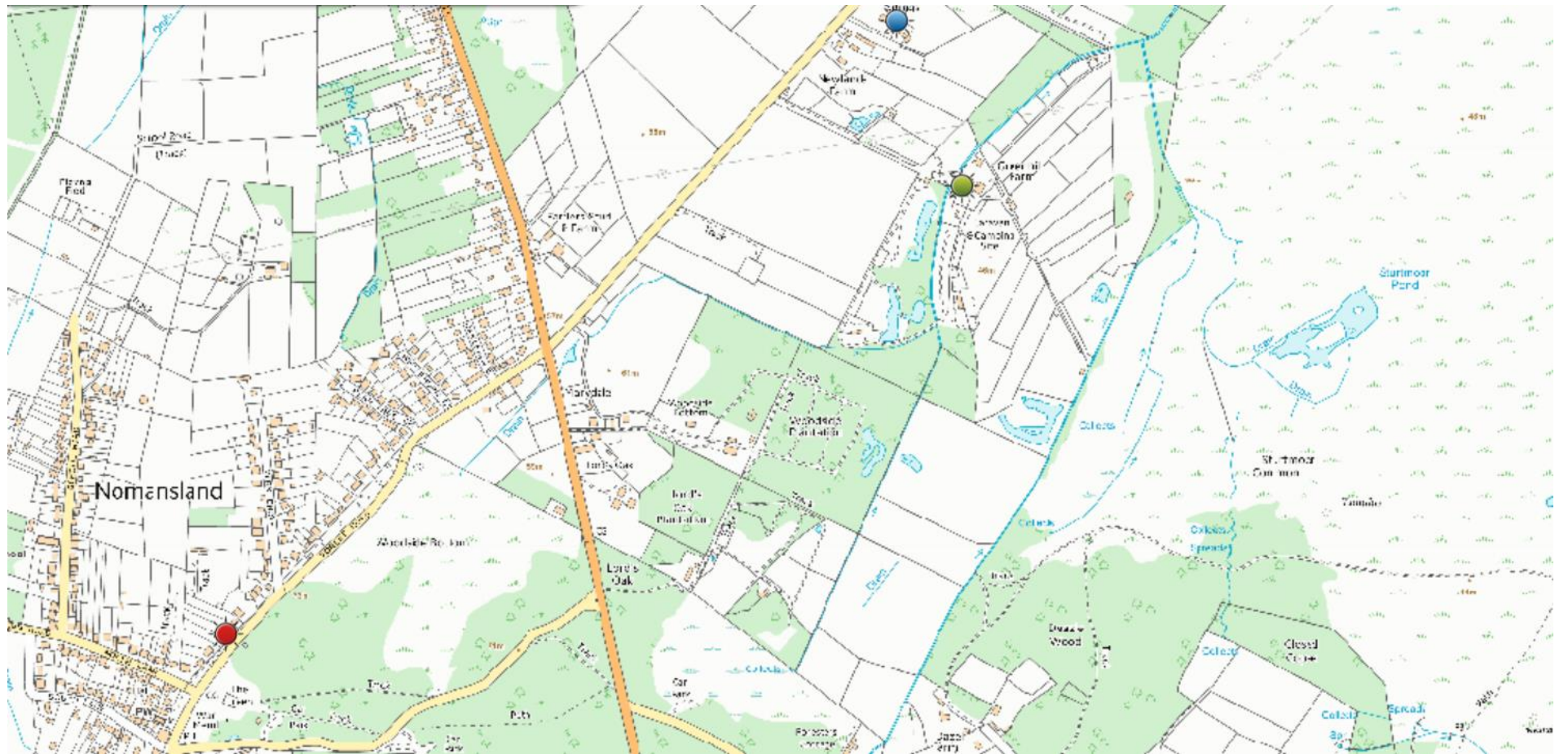

Appendix 3B– Location Plan of Premises

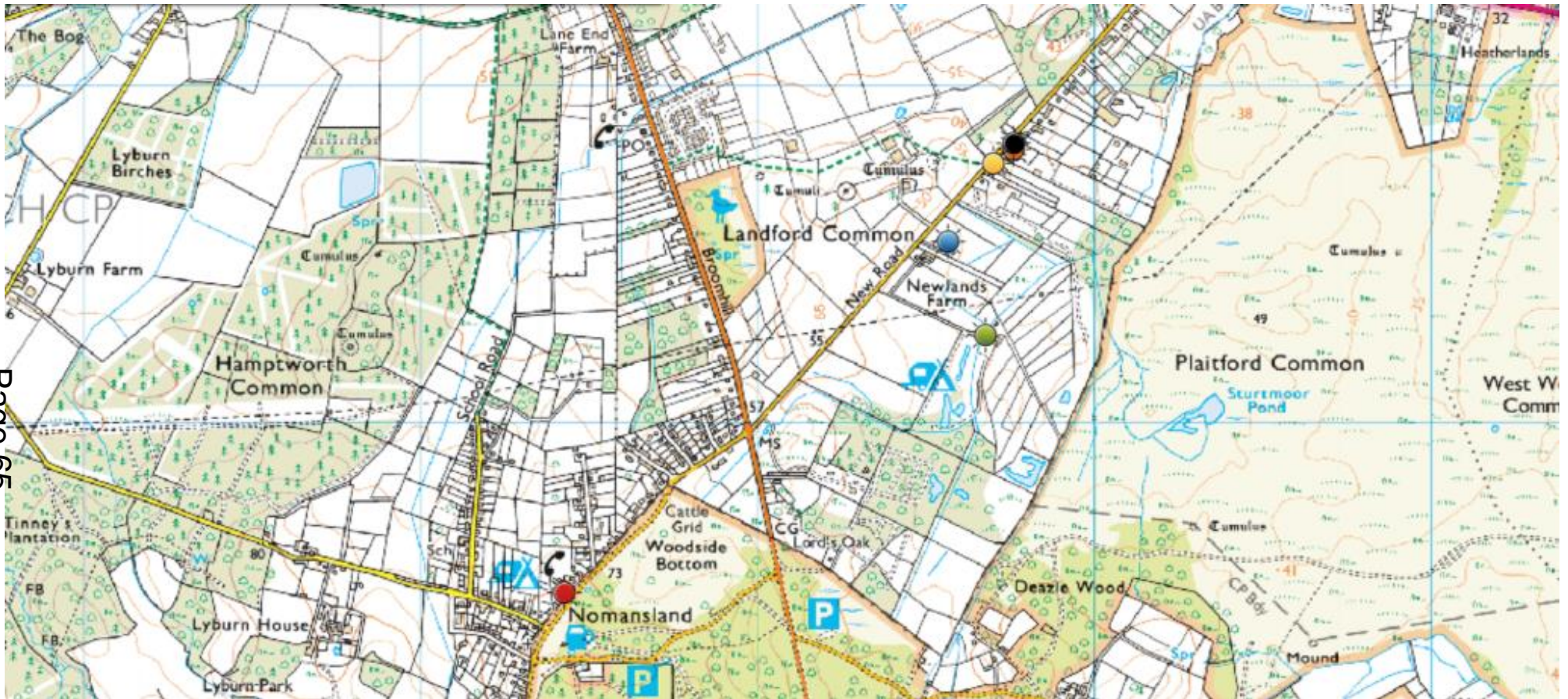

Applicant Green Hill Farm Caravan and Campsite

6. Mr and Mrs Higin - Forest Springs
7. Mrs S Smith - Rosebank Cottage
8. Ms S Hildon - The Old Orchard
9. Ms G Wilks - Boleyn Cottage
10. Ms M Lyall - Victoria Cottage

This page is intentionally left blank

 **Green Hill Farm Caravan & Camping Park**
48K like this · Camp site

7 Jan · 🌐 · ❤️ WE LOVE LOCAL ❤️ Did you know that we are located just 15 minutes drive from Paultons Park- The Home of Peppa Pig World 🌟 Rides and Attractions and NEW for 2021- Tornado Springs- a brand new world 🌟
www.paultonspark.co.uk Book your break with us for just a £25 deposit 📞 033...



15 comments

 **Green Hill Farm Caravan & Camping Park**
48K like this · Camp site

11 Feb · 🌐 · ❤️ We Love Local ❤️ The Farmers Butcher supplies Green Hill Farm with the best quality meat around We use the Farmers Butcher to supply locally sourced meats in our Cafe Bar menu and NEW for 2021 you will be able to purchase fresh meat from our on park shop plus Breakfast and BBQ Packs to...



 **Green Hill Farm Caravan & Camping Park**
48K like this · Camp site

30 Jan · 🌐 · ❤️ We Love Local ❤️ The Forest Foodie Do you know you can order a luxury hamper whilst on holiday with us- delivered fresh to your accommodation or pitch Offering...

theforestfoodie.com
Hamper Delivery | New Forest | The Forest Foodie



1 comment

 **Green Hill Farm Caravan & Camping Park**
48K like this · Camp site

16 Dec 2020 · 🌐 · ❤️ We Love Local ❤️ The Lamb Inn- Nomansland is an absolute must when staying at Green Hill Farm. Just 1 mile from the park The Lamb is traditional and family run for 20+ years young with a simple twist. 📺 Amazing Food 🍷 Log Fires 🍺 Great Local Beers 🌸 Gorgeous Award Winning...



13 comments



Green Hill Farm Caravan & Camping Park

48K like this · Camp site



24 Sep 2020 · 🌐 · ...also to say Thank you to our local supporters, Green Hill Farm will be holding 2 Drive Thru cinema nights this October. More details to be released soon but it would be great if you could tell us what you would like to see Answers below 🗨️ and watch this space for more details 🎬



22 comments



Green Hill Farm Caravan & Camping Park

48K like this · Camp site



17 Oct 2020 · 🌐 · ...This is a free of charge event for local people and guests of Green Hill and first come, first served ❤️ Doors open at 6pm- Showtime 7.30pm 🍕 PIZZA JOE'S will be joining us with their delicious pizza both nights ❤️ Call 0333 200 2790 to book, lines open 9am-5pm ^Team Green hill x



👍❤️ 3

14 comments



Green Hill Farm Caravan & Camping Park

48K like this · Camp site



26 Oct 2020 · 🌐 · ...again on Saturday but we WILL be back. The feedback we have received has been truly amazing to read and we are so glad everyone had a great time. A massive THANK YOU to all of our amazing team that supported the event at also to PIZZA JOE'S for the delicious pizzas and treats ❤️ We will ...

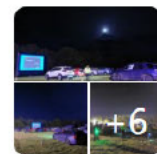

👍❤️ 49

10 comments

Local shops

Nisa Local

01794 322329

Salisbury Rd, West Wellow, SO51 6GD

Morrisons Supermarket

0238 086 4981

1 Spruce Dr, Southampton SO40 8AD

New Forest Family Butchers

01794 324111

2 Alfalie, Lower Common Rd, SO51 6BT

Reeve the Baker

01794 512479

13B The Hundred, Romsey SO51 8GD

Local takeaway restaurants

Ember Pizzeria

On park

Golden Inn Chinese Takeaway

01725 514400

B3080, Redlynch, Salisbury SP5 2HE

Goodies Fish And Chips

02380 868241

Ringwood Rd, Totton, Southampton SO40 7FA

Royal Jaipur

01794 390008

Southampton Rd, Landford, Salisbury SP5 2ED

WALKING IN THE NEW FOREST

www.thenewforest.co.uk/things-to-do/walking

Walking in the New Forest is an excellent way to truly experience our ancient woodland, beautiful heathland, pretty villages and our 40 mile 'secret coast'. Anyone with a keen passion for walking will love the 140 miles of tracks and footpaths, where you can enjoy easy to follow walking routes, short strolls or long distance trails.



CYCLING IN THE NEW FOREST

www.newforestnpa.gov.uk/things-to-do/cycling/cycling-routes/

Cycling in the New Forest gives you the chance to truly experience all the great things we have to offer and get close to our amazing nature. With over 140 miles of car-free approved cycle trails.

BUSES

www.salisburyreds.co.uk

The X7 is the closest bus route to the park (stops just outside) which goes both ways to Salisbury and Southampton with lots of stops along the way (including Paulton's Park). Please ask reception for a timetable.

MARKETS

Hythe (25 minutes' drive) - Tuesday

Lymington (30 minutes' drive) - Saturday

Ringwood (25 minutes' drive) - Wednesday

Salisbury (20 minutes' drive) - Tuesday and Saturday

TIME TO EXPLORE THE NEW FOREST

At the back of the park we have access to the New Forest (Canada Common) where you will normally find horses, ponies, cows and sometimes sheep. The gate is located just by the Sports Range and is accessible all day. Please follow the New Forest code which can be found at the entrance.

FUN FOR ALL THE FAMILY

Paultons Park and Peppa Pig World Romsey, SO51 6AL	02380 814 442
Longdown Farm Ashurst, SO40 7EH	02380 292 837
New Forest Wildlife Park Ashurst, SO40 4UH	02380 292 408

ACTION AND ADVENTURE

New Forest Water Park Fordingbridge, SP6 2EY	01425 656 868
Go Ape Ringwood, BH24 2ET	01603 895 500
Aventure Wonderland Ringwood, BH23 6BA	01202 483 444

WHEN THE SUN IS SHINING

The New Forest has plenty of pretty villages and bustling seaside towns so grab your sunscreen and shades and head into the great outdoors.

Crabbing at Lymington Harbour Don't forget your buckets, nets and bait	SO41 3SE
Milford on Sea Beach Kick back and relax in the sunshine	SO41 4PT
The New Forest Tour Bus	www.thenewforesttour.info

WET WEATHER PLAN

No matter what the weather is, there's always somewhere exciting to visit in the New Forest so grab your raincoats and brollies and explore.

The National Motor Museum Beaulieu, SO42 7ZN	01590 612 345
Buckler's Hard Maritime Museum Beaulieu, SO42 7XB	01590 616 203
Hurst Castle Milford on Sea, SO41 OTP	01590 642 500

5 Behaviour standards

By entering into this Licence Agreement, you agree to, and you must make sure that all people who use or visit the Caravan (including, in each case, children in their party) keep to, the following standards of behaviour:

- 5.1 To act in a courteous and considerate manner towards us, our staff and anyone visiting, using or working on the Caravan and/or the Park including other customers.
- 5.2 To supervise children so that they are not a nuisance or danger to themselves or other people using the Caravan and/or the Park.
- 5.3 Not to:
 - 5.3.1 Commit any criminal offence (whether or not on the Park or in its vicinity) which causes your name to be entered on the Violent and Sex Offender Register or causes you to be subject to a Risk of Sexual Harm Order or Child Abduction Warning Notice (or any register, order or notice succeeding these);
 - 5.3.2 Use the Caravan in connection with any criminal activity or commit any other criminal offence (i.e. any offence not already subject to clause 5.3.1) at the Caravan, the Park or in its vicinity;
 - 5.3.3 Commit any acts of vandalism or nuisance at the Caravan or on the Park;
 - 5.3.4 Use fireworks at the Caravan or on the Park;
 - 5.3.5 Keep or carry any firearm or any other weapon at the Caravan or on the Park;
 - 5.3.6 Keep or use any unlawful drugs at the Caravan or on the Park;
 - 5.3.7 Create undue noise or disturbance or commit antisocial behaviour at the Caravan or on the Park;
 - 5.3.8 Carry on any trade or business from the Caravan or at the Park;
 - 5.3.9 Permit anyone who is to your knowledge on the Violent and Sex Offender Register or subject to a Risk of Sexual Harm Order or a Child Abduction Warning Notice (or any register, order or notice succeeding these) to use or visit the Caravan.
- 5.4 You agree that if you or any of your Family Members or visitors or guests whom you have invited to the Park or to the Caravan break the behaviour standards listed above then we may terminate this Licence Agreement. Termination by us is dealt with by clause 11. Any serious breach may result in termination of this Agreement under clause 11.1.

6 Selling the Caravan

- 6.1 If you want to sell the Caravan you can do so:
 - 6.1.1 To us but only if we agree.
 - 6.1.2 On the Pitch to a buyer approved by us in accordance with the provisions of clause 6.2.

You confirm your understanding and agreement.	<i>Initials</i>
---	-----------------

THE SMALL THINGS MATTER

Here at Green Hill Farm, we want to ensure you have the very best holiday possible. If you can help us by following a few of our golden rules that would be great.

- No fires (including fire pits). All campfires are strictly prohibited. For a camp-fire experience join us at Ember Café Bar Fire Pit.
- Gas or charcoal BBQ's only. All BBQ's must be raised off the ground, bricks can be provided please see map for locations.
- Please drive as slowly as possible and watch out for our small explorers. Speed limit on the park is 5mph maximum.
- If you are camping or touring please ensure you are pitched as directed by your welcome team or warden to ensure safety distances are maintained.
- If playing music, please keep it low - if others can hear it, it's probably too loud.
- Quiet time is 11pm to 7am. Everybody needs sleep, rest and relaxation whilst on holiday.

Important Numbers:
Park Reception 0333 200 2790
Security Warden 07716 945571

- At all times please be respectful of others, their pitch, space and property.
- You can keep one car per pitch, all other cars should be parked at the front of the park in the overflow field.
- Please keep your pitch clean and dispose of cigarette butts in the bins and ashtrays provided.
- Please keep dogs on a lead at all times and clean up after your furry friends.
- Check out time for Forest Retreat Holiday Homes, Woodlands Safari Tents and Camping Pods is 10am.
- Please vacate your pitch by 11am on departure day, if you wish to stay longer please see reception. Subject to availability.

If you need anything at all, the team are here to help so please let us know.
Have a brilliant holiday!



Green Hill Farm

HOLIDAY VILLAGE



Green Hill Farm Holiday Village
New Road
Landford
SP5 2AZ

Katherine Edge

Public Protection Officer (Licensing)

Wiltshire County Council

Dear Katherine

Thankyou for the list of representation in relation to the Variation of premises license for Green Hill farm.

To support the application and the representation challenges, I have prepared this document that will give some clear facts and to show that as a business we have followed the four Licensing objectives.

- the prevention of crime and disorder.
- public safety.
- the prevention of public nuisance.
- the protection of children from harm

In the main, the representation for **Rep 1** will cover most of the challenges across all 5 representations but I will however respond to all 5 individually.

Please can you pass this document to the panel that will decide the application outcome in advance of the hearing.

Rep 1.

I know and have met with **Rep 1** over 3 times on park in the past 6 months and sent numerous emails, and have worked with them to ensure that our rightful development does not impact on them.

Points to address in reply:

- We have removed the option to screen outdoor film.
- Our Current license already allows us to sell alcohol until 23.00pm in our café bar.
- Considering the reduced guests and pitches, we believe we have decreased the opportunity for noise pollution and for risk to public safety. Considering our current license was based on more guests attending the park, we believe that current decrease in guests would further improve compliance in both the objectives above.
- The park has traded as a 12-month holiday park before LOVAT purchased the park in 2019. This is in our park license and is still the case. The comment from the representation is incorrect.
- The residents of our park have always had the option to purchase alcohol on their Holiday or in their holiday home and be able to purchase this onsite from March to November. We believe this option should be available to our guests all year round.
- Our park signage and customer literature enforce good behaviour and noise restrictions between 23.00pm and 07.00am. (**see document 1**)
- Bought Lovat Parks bought Green Hill Farm in June 2019, the previous owners allowed group bookings. We do not allow



- anyone greater than 2 pitches per guest so that we can ensure that noise levels are low.
- We have added holiday homes that have replaced many of our touring pitches reducing the traffic coming to and from the park.
 - Our Holiday Homeowners sign a license agreement with park rules that agree that noise and bad behaviour will not be accepted and may lead to termination of contract. **(see document 2)**
 - In terms of anti-social behaviour in 2020, we did not require the police to attend to any incident.
 - We also did not receive any noise complaints from any of our neighbours, nor from the representations for this application.
 - We promote and support local licensees and businesses. **(see document 3)**
 - Although the park does contribute to traffic and always has, I refer initially to the reduced pitch and visitor numbers reduction. The representation states that New Road is a local cut through. The owner of Lovat parks is in talks with the local community forum (John Elkins) to provide funding for a speed measuring warning device to reduce speeding by any driver be it local, business or tourist.
 - The Park Manager & his partner are local and reside on the park in the house on the park.
 - We have reduced our number of customers significantly in 2021 by the following:
 1. Reduced out touring pitches from 110 to 30.
 2. Reduced our tent pitches to from 50 to 45.
 3. We now have only 2 dedicated check in days which will reduce traffic on new road.
 4. Our average weekly customer number has dropped from 1000 to 600.
 5. Our lodge holiday homeowners do not have touring caravans and will mainly use their holiday homes at the weekend.

Rep 2.

- Lovat Parks bought Green Hill Farm in June 2019, the previous owners allowed group bookings. We do not allow anyone greater than 2 pitches per guest so that we can ensure that noise levels are low.
- In October we held an open day for residents to see the fantastic improvements we have made to the park and ask any questions. This was attended by over 65 residents and we have an open-door policy should anyone have any questions.
- Considering the reduced guests and pitches, we believe we have decreased the opportunity for noise pollution and for risk to public safety. Considering our current license was based on more guests attending the park, we believe that current decrease in guests would further improve compliance in both the objectives above.
- We promote and support local licensees and businesses. **(see document 3)**
- The Park has always had a license to sell alcohol on a Sunday.
- We have removed the option to screen outdoor film.
- In 2020 we held a cinema night for locals **(see document 3) TENS license**

Rep 3.

- We promote and support local licensees and businesses. **(see document 3)**
- Our Current license already allows us to sell alcohol until 23.00pm in our café bar.
- In 2020 we held a cinema night for **locals (see document 3) TENS license**
- Although the park does contribute to traffic and always has, I refer initially to the reduced pitch and visitor numbers reduction. The representation states that New Road is a local cut through. The owner of Lovat parks is in talks with the local community forum (John Elkins) to provide funding for a speed measuring warning device to reduce speeding by any driver be it local, business or tourist.
- In October we held an open day for residents to see the fantastic improvements we have made to the park and ask any questions. This was attended by over 65 local residents and we have an open-door policy should anyone have any questions.

Green Hill Farm

HOLIDAY VILLAGE



Rep 4.

- We promote and support local licensees and businesses. **(see document 3)**
- Our Current license already allows us to sell alcohol until 23.00pm in our café bar.
- In 2020 we held a cinema night for **locals (see document 3) TENS license**
- The owner of Lovat parks is in talks with the local community forum (John Elkins) to provide funding for a speed measuring warning device to reduce speeding by any driver be it local, business or tourist.
- Although the park does contribute to traffic and always has, I refer initially to the reduced pitch and visitor numbers reduction. The representation states that New Road is a local cut through.

Rep 5.

- Lovat have offered to support local litter picks with the parish council although no evidence supports the litter is from guests of the park.
- In October we held an open day for residents to see the fantastic improvements we have made to the park and ask any questions.
- The owner of Lovat parks is in talks with the local community forum (John Elkins) to provide funding for a speed measuring warning device to reduce speeding by any driver be it local, business or tourist.
- We promote and support local licensees and businesses. **(see document 3) see promotion of New forest rules.**
- We have reduced our number of customers significantly in 2021 by the following:
 1. Reduced out touring pitches from 110 to 30.
 2. Reduced our tent pitches to from 50 to 45.
 3. We now have only 2 dedicated check in days which will reduce traffic on new road.
 4. Our average weekly customer number has dropped from 1000 to 600 in peak season and 700 to 400 in off peak.
 5. Our lodge holiday homeowners do not have touring caravans and will mainly use their holiday homes at the weekend.

Executive Summary

Green Hill Farm has ensured that we do our very best to work with communities and businesses within that community in a safe and respectful way. We are proud of the fact that Green Hill Farm has been featured in numerous national publications in the past 12 months for example-

<https://www.thetimes.co.uk/article/the-30-best-eco-escapes-8nsrj8z0g>

<https://www.telegraph.co.uk/travel/safaris-and-wildlife/great-british-getaways-10-amazing-uk-wildlife-holidays-2021/>

<https://www.theguardian.com/travel/2020/sep/05/top-10-october-half-term-family-childrens-holidays-uk-britain>

We have shown that we have further support initiatives that benefit the community and care about our neighbours. This is part of why we became the first holiday park operator in the world to get BCorp certification after 15 months of rigorous external assessment (www.bcorporation.uk). We truly believe that business can be a force for good and we all have a duty to promote sustainable tourism.

Furthermore, we supply the following facts which target the four licensing objectives, that were the same objectives when the council granted the license for 2020.

Green Hill Farm

HOLIDAY VILLAGE



- Reduced the pitches and guests using the park versus 2019/2020.
- The Fire Officer had no objections and would like to visit to support any initiatives.
- The police have not responded to the copy of the application, but we will send another copy to the registered post.
- We had zero police call outs for noise or nuisance.
- The representations are at least 500 m from the café bar, and this has not changed for the existing license. **(see closest neighbour doc)**
- Our Current license already allows us to sell alcohol until 23.00pm in our café bar.
- There have been no complaints made to the EHO regarding noise.

Thank you for taking time to read the document to support our application.

Should you need any further information please contact me directly.

Ross Birkett

General Manager

Ross.birkett@lovatparks.com

07774453626

This page is intentionally left blank

Representations in respect of the new off-licence building and variation to the premises licence.

I wish to make representations on behalf of my wife and I against the variation application which seeks to create a new off-licensed building in its proposed new location. We are not making any representations against the application in respect of the existing on- and off-licence building sited elsewhere on the caravan park.

Prevention of public nuisance

My wife and I have lived here for twenty years and for all that time, until recently, we were unaware of the existence of the caravan park on a day-by-day basis and only exceptionally could we hear any people noise. There is a very good reason for that. The operators have recently started to clear the land between our house and the new proposed location, and over the last five months trees, shrubs and dense vegetation has been removed, which afforded a natural acoustic barrier between us and the site.

This thinning of the vegetation is demonstrated by photos 1, 2, 3 and 4. Photo 1 shows that we could see nothing at night previously, Photo 2 highlights the removal of trees and shrubs as the light pollution is now significant. Photo 3 was taken shortly after they had commenced removing this natural sound barrier, and photo 4 shows the current situation, we have been informed by the operator that they are planting a laurel hedge (photo 4 and 5) but that will take years to come to maturity and be an effective sound barrier. That photo (photo 4) also shows our house, and the intervisibility is new, following the removal of the intervening trees.

The off-licence seeks to operate later in the evening than currently, and the building will be closer to our house than before. This is shown on the aerial photograph 6. This photo also really highlights the amount of vegetation there used to be between the old off licence and the surrounding neighbours that has now gone. Background noise levels are lower in the evening than in the daytime.

We are concerned that the off-licence will operate later into the evening and closer to our house than has previously been the case, and that without the imposition of strict conditions there will be a nuisance from customers using the facility.

We consider that conditions are necessary as it is our experience that we cannot always rely on the promised goodwill of the operators. For example, Green Hill Park advises in its

supporting documentation that they have engaged with local residents (specifically us), but we can advise that communication with them has only ever been initiated by us and has been incredibly limited on their part. We have never been approached by GHP or consulted on any matter that impacts on us. We were not invited to any open days, despite having provided GHP with our contact details and made them aware of our address and proximity to the site. Recently (on Sunday 28th March), trees on our property cut back in order to facilitate fibre internet being connected to GHP. We were not notified of the tree surgeon accessing our property or cutting our trees (despite the tree surgeon's admission when questioned that we should have been notified).

When we initially complained about the screening, we were ignored. On subsequent attempts to communicate with Green Hill Farm, we were told that screening would be put in place around the re-sited car park and reception building by November 2020. As of March 2021, no screening had been put in place and we were continuously told that screening had been delayed. However, as you can see from Picture 5, the screening is completely ineffectual in terms of noise pollution. It is also in no way a replacement for the metres of thick vegetation and mature trees that existed there previously.

We would ask the Members to consider some or all of the following conditions, or others which Members consider will be:

1. Provide an acoustic barrier to prevent noise reaching neighbours' property. There needs to be directions as to the location, height, specification and so on, and the authority's own environmental health officers can provide the technical input. Given that GHP have moved the location of the off-licence for their own commercial benefit, ensuring the status quo of the previous location should be a condition of granting the licence.
2. Reducing the hours sought in the evening. The other licensed premises on site has an on- and off-licence and customers can access those premises until late in the evening.
3. Using security staff to monitor the behaviour of customers and as a reminder of the need to act with consideration to other park users and neighbours.

We are not opposed to the off-licence facility. We are concerned only to ensure that its operation also respects our right not to be disturbed and our enjoyment of our home is protected.

9



82









Appendix 4A

Response to Applicants comment on Representations

1. Mr and Mrs Higgins	<p>Thank you very much for your email, although this information does not alleviate our concerns. I would like to reply in full, and hope to do so over the next few days. In short, we feel that several of the statements made by Lovat Parks are misleading and erroneous. We also feel that Lovat Parks have not addressed our concerns directly.</p> <p>Lisa Higgins</p>	
2. Ms S Smith	<p>Thank you for this information, I do still have concerns and do not feel that the supplied documents are of any comfort or reassurance.</p> <p>Unfortunately what they have failed to take into account is that when in an area such as ours noise travels a distance and whilst the maps shows we are of some distance from them we can hear them every day whilst they have been having works carried out in the park ! Maybe if that hadn't taken down so many trees this would be helping but unfortunately a licence to sell alcohol as they have applied for will only create a lot of noise. Last years noise levels were awful and that was without an alcohol extension to what they have hence our objection.</p> <p>I will be attending the hearing.</p>	
3.	-	
4. Ms G Wilks	<p>Complaints were made to the PC from what I've heard but maybe that was not sufficient. I'm sure this can be rectified.</p>	
5.	-	

This page is intentionally left blank

Appendix 4B Removal of Film Outdoors

Hi Katherine

Sorry Monday is just so busy and my first chance to respond.

Lets take it off then

Thankyou

Ross

.....

Good Morning Ross,

If you would be applying for TENS for outdoor films, would you consider removing the outdoor film from the variation licence application?

Regards

Katherine Edge

.....

Hi Katherine

I can explain exactly what we would use this part of the license for:

The Café bar will have a pull down projector that is covered and indoors , that would show cartoons/kids films on rainy days for our guests.

Last year we put on a drive through cinema and obtained a TENS for this. Note that this event was put on for the Landford community and my guests and over 200 local residents of the parish attended.

This was put on as a half term gesture to entertain the local community. We have planned to do another night in 2021 for the community but this would be another TENS application.

In short, we would not be utilising the option for Film very much and it wouldn't be outdoors unless a TENS was applied for as a one off for the community.

I hope this helps?

Ross

.....

Ross,

I have received the following email from Landford Parish Council.

Although this is not yet a valid representation, are you able to provide information to reassure the Council of your intentions for the use of Films.

LPC has considered the application for a full variation of a premises licence at Green Hill Farm, Caravan and Campsite, and would comments as follows:-

Resolved unanimously that:-

- * Extend the alcohol trading hours: NO OBJECTION
- * Exhibition of films 9am to 10pm 7 days a week indoors/outdoors: OBJECT

The proposal to exhibit films outdoors with such frequency is not in keeping with the Environment Act 1995, first statutory purpose being To conserve and enhance the natural beauty, wildlife, and cultural heritage of the area. Plus the need to protect dark night skies. The Parish Council would therefore wish to see much tighter restrictions on the frequency to exhibit films outdoors.

The councillors have asked that I cc NFNPA into this response so that they may consider if there are any planning requirements on plans to exhibit outdoor films.

Please acknowledge receipt of this response.

Kind regards

Clerk & Responsible Financial Officer

Landford Parish Council

Regards

Katherine Edge

Public Protection Officer (Licensing)